

# CREATE YOUR COMBO TRAIN STATION COMBO

Product Numbers FK020, FK021



## DETAILS

### CONSTRUCTION

- Solid foam construction
- MDF baseboard to fit foot options
- Reinforced seams and stitching
- Made in USA
- Backed with a lifetime warranty

### MODIFICATION

- Seat height
- Textile and placement
- Leg and foot options
- Fully zippered (no wood base)
- Colored stitching and zipper
- Embroidery

## COMBO BREAKDOWN

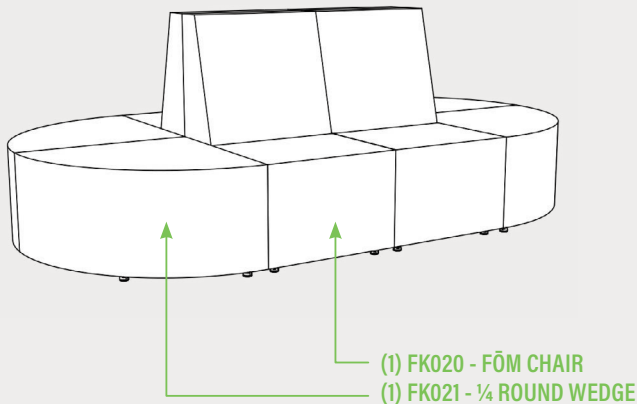

## HOW TO SPECIFY A TRAIN STATION

### STEP 1: SEAT HEIGHT

FOM CHAIR	
DIMENSION (L x W x H)	SEAT HEIGHT
16" x 18" x 23.25"	10"
21" x 26.5" x 35"	16"
24" x 30" x 39.5"	18"

1/4 ROUND WEDGE	
DIMENSION (L x W x H)	SEAT HEIGHT
18" x 18" x 10"	10"
26.5" x 26.5" x 16"	16"
30" x 30" x 18"	18"

### STEP 2: FOOT AND FULLY ZIPPERED

#### FULLY ZIPPERED



\*Reference the product breakdown on back for availability.

#### 1" STANDARD FOOT OPTIONS

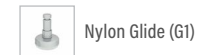

### STEP 3: GRADE AND TEXTILE

#### GRADES & SWATCHES



[CLICK TO VIEW »](#)

#### FABRIC DIRECTION & COLOR GUIDES

##### FOM CHAIR



[CLICK TO VIEW »](#)

##### 1/4 ROUND WEDGE



[CLICK TO VIEW »](#)

\*Thread will default to match the seat textile.

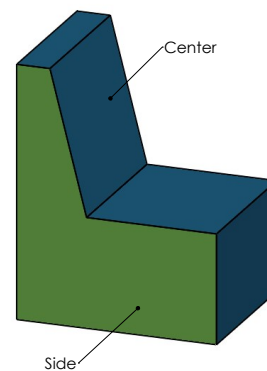

#### COLOR GUIDES

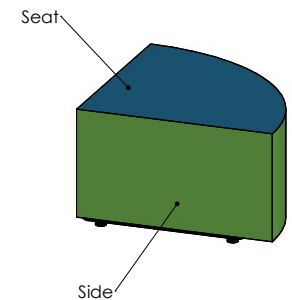

### STEP 4: ACCESSORIES (OPTIONAL)

#### EMBROIDERY

- Personalize your furniture with embroidery!
- We can embroider logos up to 12" x 15".

#### EMBROIDERY SPECS

[CLICK TO VIEW »](#)



#### CAL TB-133

- Optional flame retardant add on.

\*Reference the product breakdown on back for availability.

## STEP 5: CONFIGURE PART NUMBER

### FILL IN YOUR PART NUMBER

[ ]	[ ]	[ ]	[ ]	[ ]	[ ]	-	[ ]	[ ]	x	[ ]	[ ]	[ ]	[ ]	x	[ ]	[ ]	[ ]	[ ]	[ ]	-	[ ]	[ ]	[ ]
FAMILY				STEP 1												FOOT/ZIP				STEP 2			

### EXAMPLE PART NUMBER

F	K	0	2	0	-	1	6	x	1	8	x	2	3	.2	5	-	G	1	
FAMILY				STEP 1												FOOT/ZIP			

## STEP 6: CONFIGURE DESCRIPTION

### FILL IN YOUR DESCRIPTION

<b>1. SEAT</b>					STEP 3
1. Seat	[ ]	[ ]	[ ]	[ ]	
LOCATION	GRADE	MANUFACTURER	PATTERN	COLOR	
<b>2. SIDE</b>					
2. Side	[ ]	[ ]	[ ]	[ ]	
LOCATION	GRADE	MANUFACTURER	PATTERN	COLOR	
<b>FOOT</b>		<b>EMBROIDERY*</b>			
[ ]	[ ]	[ ]	[ ]	[ ]	
NAME/COLOR	LOCATION	NAME			
<b>FLAME RETARDANT*</b>					
[ ]	[ ]	[ ]	[ ]	[ ]	

### EXAMPLE DESCRIPTION

<b>1. SEAT</b>				
1. Seat	1	Spradling	Silvertex	Sage
LOCATION	GRADE	MANUFACTURER	PATTERN	COLOR
<b>2. SIDE</b>				
2. Side	3	Momentum	Tribeca	Fossil
LOCATION	GRADE	MANUFACTURER	PATTERN	COLOR
<b>FOOT</b>		<b>EMBROIDERY*</b>		
1" Nylon Glide	[ ]	Seat	[ ]	Rocket Logo
NAME/COLOR	LOCATION	NAME		
<b>FLAME RETARDANT*</b>				
CAL TB-133				

\*Optional add-ons. Reference product breakdown for availability.

REPEAT STEP 5 & 6 FOR EACH PRODUCT NUMBER.

## EXAMPLE CONFIGURATION

FK020-16x18x23.25-G1

1. Seat: Grade 1, Spradling, Silvertex, Sage | 2. Side: Grade 3, Momentum, Tribeca, Fossil

Foot: 1" Nylon Glide | Embroidery: Seat, Rocket logo | CAL TB-133

## PRODUCT BREAKDOWN

### TRAIN STATION COMBO

Description/ Product No.	Dimen./Weight (L x W x H)	FOOT OPTIONS												INTEGRATED POWER OPTION										TFL	Emb.	
		Zip Z	Standard			3" Premium			6" Premium						Standard		3" Premium		6" Premium							
			G1	L1		R3	C3	S16	S29	C6	T6	R6	M6	G1	L1	R3	C3	S16	S29	C6	T6	R6	M6			
Föm Chair FK020-16x18x23.25	16" x 18" x 23.25" 8 lbs. (10" Seat Height)	✓	✓	✓	-	-	-	-	-	-	-	-	-	-	-	-	-	-	-	-	-	-	-	-	-	✓
Föm Chair FK020-21x26.5x35	21" x 26.5" x 35" 18 lbs. (16" Seat Height)	✓	✓	✓	-	-	-	-	-	-	-	-	-	-	-	-	-	-	-	-	-	-	-	-	-	✓
Föm Chair FK020-24x30x39.5	24" x 30" x 39.5" 26 lbs. (18" Seat Height)	✓	✓	✓	-	-	-	-	-	-	-	-	-	-	-	-	-	-	-	-	-	-	-	-	-	✓
¼ Round Wedge FK021-18x18x10	18" x 18" x 10" 6 lbs.	✓	✓	✓	-	-	-	-	-	-	-	-	-	-	-	-	-	-	-	-	-	-	-	-	-	✓
¼ Round Wedge FK021-26.5x26.5x16	26.5" x 26.5" x 16" 16 lbs.	✓	✓	✓	-	-	-	-	-	-	-	-	-	-	-	-	-	-	-	-	-	-	-	-	-	✓
¼ Round Wedge FK021-30x30x18	30" x 30" x 18" 22 lbs.	✓	✓	✓	-	-	-	-	-	-	-	-	-	-	-	-	-	-	-	-	-	-	-	-	-	✓



### ADDITIONAL RESOURCES



[CLICK TO VIEW »](#)

INCLUDE ON PURCHASE ORDER