

WEATHER RESISTANT SERIES

WEATHER RESISTANT ROUND OTTOMAN

Product No. FW005

Soft, durable, quick drying, lightweight, and weather resistant is what you can expect from Fōmcore's new outdoor-friendly furniture. Produced using marine grade nylon thread and Bayside vinyl with UV and fade resistant protection, you can enjoy the same Fōmcore quality and craftsmanship backed with a 3-year warranty.



DETAILS

CONSTRUCTION

- Solid foam construction
- Reinforced seams and stitching
- Marine grade Bayside textile
- Exterior wood base
- Made in USA
- Backed with a 3-year warranty

MODIFICATION

- Seat height
- Stitching color
- Bayside textile color

QUICK COMBOS

FW101, FW005

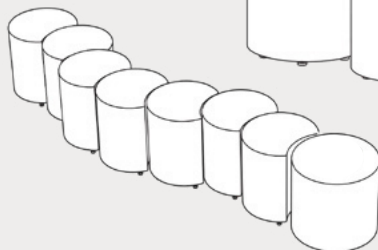
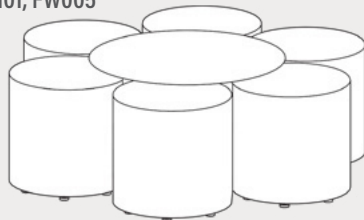

FW003, FW005



HOW TO SPECIFY FW005

STEP 1: SEAT HEIGHT

DIMENSION (DIA. x H)	SEAT HEIGHT	DIMENSION (DIA. x H)	SEAT HEIGHT	DIMENSION (DIA. x H)	SEAT HEIGHT
 18"	12"	 30"	12"	 36"	12"
	14"		14"		14"
	16"		16"		16"
	18"		18"		18"
	20"				

STEP 2: FOOT

1" STANDARD FOOT OPTION



STEP 3: GRADE AND TEXTILE

WEATHER RESISTANT PRODUCTS ONLY AVAILABLE IN BAYSIDE:

	Apple		Fern		Putty		Taupe
	Bamboo		Greige		Red Pear		Tofu
	Berry		Lt. Sand		Shell		Turquoise
	Birch		Med Grey		Sky Grey		Vanilla
	Champagne		Navy		Slate		Violet
	Empire Tan		Pebble		Spicy		Warm Grey
	Espresso		Periscope		Sugar		White

BAYSIDE VINYL



[CLICK TO VIEW »](#)

FABRIC DIRECTION & COLOR GUIDE



[CLICK TO VIEW »](#)

COLOR GUIDE

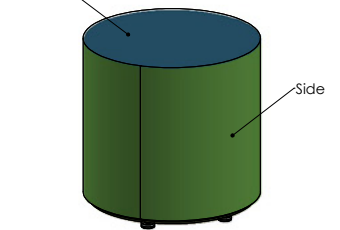

*Thread will default to match the seat textile.

STEP 4: CONFIGURE PART NUMBER

FILL IN YOUR PART NUMBER

F	W	0	0	5	-		x		-	L	1
FAMILY						DIA H				FOOT	
					STEP 1					STEP 2	

EXAMPLE PART NUMBER

F	W	0	0	5	-	1	8	x	1	8	-	L	1
FAMILY						DIA H				FOOT			

STEP 5: CONFIGURE DESCRIPTION

FILL IN YOUR DESCRIPTION

1. SEAT

1. Seat	1	Morbern	Bayside	
LOCATION	GRADE	MANUFACTURER	PATTERN	COLOR

2. SIDE

2. Side	1	Morbern	Bayside	
LOCATION	GRADE	MANUFACTURER	PATTERN	COLOR

FOOT

1" Low Profile Leg - Black
NAME/COLOR

STEP 3

EXAMPLE DESCRIPTION

1. SEAT

1. Seat	1	Morbern	Bayside	Apple
LOCATION	GRADE	MANUFACTURER	PATTERN	COLOR

2. SIDE

2. Side	1	Morbern	Bayside	Navy
LOCATION	GRADE	MANUFACTURER	PATTERN	COLOR

FOOT

1" Low Profile Leg - Black
NAME/COLOR

INCLUDE ON PURCHASE ORDER

EXAMPLE CONFIGURATION

FW005-18x18-L1

1. Seat: Grade 1, Morbern, Bayside, Apple | 2. Side: Grade 1, Morbern, Bayside, Navy

Foot: 1" Low Profile Leg Black

PRODUCT BREAKDOWN

ROUND OTTOMAN (FW005)

Product No.	Dimen./Weight (Dia x H)	FOOT OPTIONS												INTEGRATED POWER OPTIONS						TFL	Emb.				
		Zip Z	Standard		3" Premium		6" Premium						Standard		3" Premium		6" Premium								
			G1	L1	R3	C3	S16	S29	C6	T6	R6	M6	G1	L1	R3	C3	S16	S29	C6			T6	R6	M6	
FW005-18x12	18" x 12" 7 lbs.	-	-	✓	-	-	-	-	-	-	-	-	-	-	-	-	-	-	-	-	-	-	-	-	-
FW005-18x14	18" x 14" 8 lbs.	-	-	✓	-	-	-	-	-	-	-	-	-	-	-	-	-	-	-	-	-	-	-	-	-
FW005-18x16	18" x 16" 9 lbs.	-	-	✓	-	-	-	-	-	-	-	-	-	-	-	-	-	-	-	-	-	-	-	-	-
FW005-18x18	18" x 18" 10 lbs.	-	-	✓	-	-	-	-	-	-	-	-	-	-	-	-	-	-	-	-	-	-	-	-	-
FW005-18x20	18" x 20" 11 lbs.	-	-	✓	-	-	-	-	-	-	-	-	-	-	-	-	-	-	-	-	-	-	-	-	-
FW005-30x12	30" x 12" 18 lbs.	-	-	✓	-	-	-	-	-	-	-	-	-	-	-	-	-	-	-	-	-	-	-	-	-
FW005-30x14	30" x 14" 19 lbs.	-	-	✓	-	-	-	-	-	-	-	-	-	-	-	-	-	-	-	-	-	-	-	-	-
FW005-30x16	30" x 16" 20 lbs.	-	-	✓	-	-	-	-	-	-	-	-	-	-	-	-	-	-	-	-	-	-	-	-	-
FW005-30x18	30" x 18" 22 lbs.	-	-	✓	-	-	-	-	-	-	-	-	-	-	-	-	-	-	-	-	-	-	-	-	-
FW005-36x12	36" x 12" 25 lbs.	-	-	✓	-	-	-	-	-	-	-	-	-	-	-	-	-	-	-	-	-	-	-	-	-
FW005-36x14	36" x 14" 27 lbs.	-	-	✓	-	-	-	-	-	-	-	-	-	-	-	-	-	-	-	-	-	-	-	-	-
FW005-36x16	36" x 16" 29 lbs.	-	-	✓	-	-	-	-	-	-	-	-	-	-	-	-	-	-	-	-	-	-	-	-	-
FW005-36x18	36" x 18" 31 lbs.	-	-	✓	-	-	-	-	-	-	-	-	-	-	-	-	-	-	-	-	-	-	-	-	-

ADDITIONAL RESOURCES



CLICK TO VIEW »