

LOTUS SERIES LOG OTTOMAN

Product No. FK501

Looking for a desk to keep students alert, safe, and accommodate appropriate movement? The Fōm Desk is the answer to create space for focused learning. Paired with a fully zippered ottoman, the fully zippered, solid foam construction continues the theme of mobility and provides a soft touch and safe environment for the learner.



DETAILS

CONSTRUCTION

- Solid foam construction
- Reinforced seams and stitching
- Fully zippered (no wood base)
- Made in USA
- Backed with a lifetime warranty

MODIFICATION

- Textile & placement
- Colored stitching and zipper
- Embroidery

CAMPFIRE COMBO WITH 16" LOG OTTOMANS



CAMPFIRE COMBO WITH 48" LOG OTTOMANS

HOW TO SPECIFY FK501

STEP 1: SEAT HEIGHT

DIMENSION (LxW)	HEIGHT
17" x 15"	16"
	18"

DIMENSION (LxW)	HEIGHT
18" x 15"	16"
	18"
	48"

STEP 2: FULLY ZIPPERED

FULLY ZIPPERED



Fully Zippered (Z)

**Reference the product breakdown on back for availability.*

STEP 3: GRADE AND TEXTILE

GRADES & SWATCHES



[CLICK TO VIEW »](#)

FABRIC DIRECTION & COLOR GUIDE



[CLICK TO VIEW »](#)

COLOR GUIDE

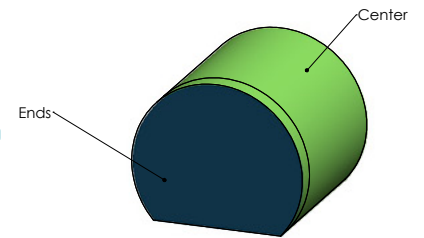

**Thread will default to match the seat textile.*

STEP 4: ACCESSORIES (OPTIONAL)

EMBROIDERY

- Personalize your furniture with embroidery!
- We can embroider logos up to 12" x 15".

EMBROIDERY SPECS

[CLICK TO VIEW »](#)



CAL TB-133

- Optional flame retardant add on.

**Reference the product breakdown on back for availability.*

STEP 5: CONFIGURE PART NUMBER

FILL IN YOUR PART NUMBER

F	K	5	0	1	-	x	x	x	x	-				
FAMILY						STEP 1				STEP 2				
L					W				H			ZIP		

EXAMPLE PART NUMBER

F	K	5	0	1	-	1	7	x	1	5	x	1	8	-	Z			
FAMILY						L				W			H			ZIP		

STEP 6: CONFIGURE DESCRIPTION

FILL IN YOUR DESCRIPTION

1. ENDS

1. Ends				
LOCATION	GRADE	MANUFACTURER	PATTERN	COLOR

2. CENTER

2. Center				
LOCATION	GRADE	MANUFACTURER	PATTERN	COLOR

EMBROIDERY*

LOCATION	NAME

FLAME RETARDANT*

--

STEP 3

EXAMPLE DESCRIPTION

1. ENDS

1. Ends	1	Spradling	Silvertex	Sage
LOCATION	GRADE	MANUFACTURER	PATTERN	COLOR

2. CENTER

2. Center	3	Momentum	Tribeca	Fossil
LOCATION	GRADE	MANUFACTURER	PATTERN	COLOR

EMBROIDERY*

Seat	Rocket Logo
LOCATION	NAME

FLAME RETARDANT*

CAL TB-133

*Optional add-ons. Reference product breakdown for availability.

INCLUDE ON PURCHASE ORDER

EXAMPLE CONFIGURATION

FK501-17x15x18-Z

1. Ends: Grade 1, Spradling, Silvertex, Sage | 2. Center: Grade 3, Momentum, Tribeca, Fossil

Embroidery: Seat, Rocket logo | CAL TB-133

PRODUCT BREAKDOWN

LOG OTTOMAN (FK501)

Product No.	Dimen./Weight (L x W x H)	Zip Z	FOOT OPTIONS												INTEGRATED POWER OPTION								TFL	Emb.	
			Standard		3" Premium		6" Premium				Standard		3" Premium		6" Premium										
			G1	L1	R3	C3	S16	S29	C6	T6	R6	M6	G1	L1	R3	C3	S16	S29	C6	T6	R6	M6			
FK501-17x15x16	17" x 15" x 16" 4 lbs.	✓	-	-	-	-	-	-	-	-	-	-	-	-	-	-	-	-	-	-	-	-	-	-	✓
FK501-17x15x18	17" x 15" x 18" 5 lbs.	✓	-	-	-	-	-	-	-	-	-	-	-	-	-	-	-	-	-	-	-	-	-	-	✓
FK501-18x15x16	18" x 15" x 16" 5 lbs.	✓	-	-	-	-	-	-	-	-	-	-	-	-	-	-	-	-	-	-	-	-	-	-	✓
FK501-18x15x18	18" x 15" x 18" 5 lbs.	✓	-	-	-	-	-	-	-	-	-	-	-	-	-	-	-	-	-	-	-	-	-	-	✓
FK501-18x15x48	18" x 15" x 48" 11 lbs.	✓	-	-	-	-	-	-	-	-	-	-	-	-	-	-	-	-	-	-	-	-	-	-	✓

Fōmcore
SERVE. CREATE. INSPIRE.

1770 E. Keating Ave - Muskegon, MI 49442 • Tel: 231.366.4791 • www.fomcore.com

ADDITIONAL
RESOURCES



CLICK TO VIEW »