

LOTUS SERIES | SENSORY AND SAFE  
**HUG CHAIR 2.0**

Product No. FK034

Sometimes, we all need a hug to feel better. The Hug Chair 2.0 mimics the original design of our Hug Chair with a few changes. When a student sits in the chair, the inverted arms create a light, calming reassurance. The rounded outside profile supports their arms hanging down, and the widened base allows for free movement of the hips. The Hug Chair 2.0 gives students an opportunity to self-regulate and keep the environment safe.



**DETAILS**

**CONSTRUCTION**

- Solid foam construction
- Reinforced seams and stitching
- Fully zippered (no wood base)
- Made in USA
- Backed with a lifetime warranty

**MODIFICATION**

- Textile & placement
- Colored stitching and zipper
- Embroidery



**HOW TO SPECIFY FK034**

**STEP 1: HEIGHT**

DIMENSION (L x W x H)	SEAT HEIGHT	DIMENSION (L x W x H)	SEAT HEIGHT
 30" x 15" x 28.5" (Junior)	15"	 35" x 15" x 30.5" (XL)	17"

**STEP 2: FULLY ZIPPERED**

**FULLY ZIPPERED**



Fully Zippered (Z)

*\*Reference the product breakdown on back for availability.*

**STEP 3: GRADE AND TEXTILE**

**GRADES & SWATCHES**



[CLICK TO VIEW »](#)

**FABRIC DIRECTION & COLOR GUIDE**



[CLICK TO VIEW »](#)

**COLOR GUIDE**

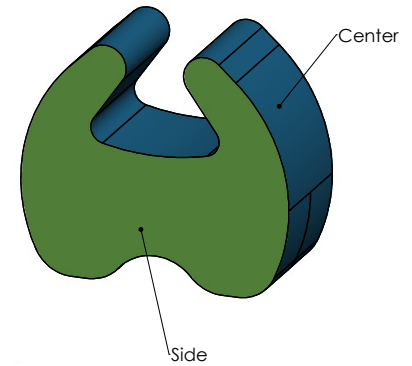

*\*Thread will default to match the seat textile.*

**STEP 4: ACCESSORIES (OPTIONAL)**

**EMBROIDERY**

- Personalize your furniture with embroidery!
- We can embroider logos up to 12" x 15".

**EMBROIDERY SPECS**

[CLICK TO VIEW »](#)



**CAL TB-133**

- Optional flame retardant add on.

*\*Reference the product breakdown on back for availability.*

## STEP 5: CONFIGURE PART NUMBER

### FILL IN YOUR PART NUMBER

F	K	0	3	4	-	3	0	x	1	5	x	2	8	.5	-	Z		
FAMILY				STEP 1										STEP 2				
L				W				H				ZIP						

### EXAMPLE PART NUMBER

F	K	0	3	4	-	3	0	x	1	5	x	2	8	.5	-	Z		
FAMILY				STEP 1										STEP 2				
L				W				H				ZIP						

## STEP 6: CONFIGURE DESCRIPTION

### FILL IN YOUR DESCRIPTION

#### 1. BANDING

1. Banding				
LOCATION	GRADE	MANUFACTURER	PATTERN	COLOR

#### 2. SIDE

2. Side				
LOCATION	GRADE	MANUFACTURER	PATTERN	COLOR

STEP 3

#### EMBROIDERY\*

LOCATION	NAME
----------	------

#### FLAME RETARDANT\*

--

### EXAMPLE DESCRIPTION

#### 1. BANDING

1. Banding	1	Spradling	Silvertex	Sage
LOCATION	GRADE	MANUFACTURER	PATTERN	COLOR

#### 2. SIDE

2. Side	3	Momentum	Tribeca	Fossil
LOCATION	GRADE	MANUFACTURER	PATTERN	COLOR

#### EMBROIDERY\*

Side	Rocket Logo
LOCATION	NAME

#### FLAME RETARDANT\*

CAL TB-133
------------

\*Optional add-ons. Reference product breakdown for availability.

INCLUDE ON PURCHASE ORDER

## EXAMPLE CONFIGURATION

FK034-30x15x28.5-Z

1. Banding: Grade 1, Spradling, Silvertex, Sage | 2. Side: Grade 3, Momentum, Tribeca, Fossil

Embroidery: Side, Rocket logo | CAL TB-133

## PRODUCT BREAKDOWN

### HUG CHAIR 2.0 (FK034)

Product No.	Dimen./Weight (L x W x H)	FOOT OPTIONS											INTEGRATED POWER OPTIONS						TFL	Emb.			
		Zip Z	Standard G1 L1		3" Premium R3 C3		6" Premium S16 S29 C6 T6 R6 M6				Standard G1 L1		3" Premium R3 C3		6" Premium S16 S29 C6 T6 R6 M6								
Junior FK034-30x15x28.5	30" x 15" x 28.5" 8 lbs. (15" Seat Height)	✓	-	-	-	-	-	-	-	-	-	-	-	-	-	-	-	-	-	-	-	-	✓
XL FK034-35x15x30.5	35" x 15" x 30.5" 11 lbs. (17" Seat Height)	✓	-	-	-	-	-	-	-	-	-	-	-	-	-	-	-	-	-	-	-	-	✓



#### ADDITIONAL RESOURCES



CLICK TO VIEW »