

# LOTUS SERIES | SENSORY AND SAFE HUG CHAIR

Product No. F721

Sometimes, we all need a hug to feel a little better. The Hug Chair is constructed with a firm foam and is fully zippered. When a learner positions themselves into the chair, they will feel a calming reassurance front and back or side to side giving the student an opportunity to self-regulate and keep the environment safe.



## DETAILS

### CONSTRUCTION

- Solid foam construction
- Reinforced seams and stitching
- Fully zippered (no wood base)
- Made in USA
- Backed with a lifetime warranty



### MODIFICATION

- Textile & placement
- Colored stitching and zipper
- Embroidery



## HOW TO SPECIFY F721

### STEP 1: HEIGHT

DIMENSION (L x W x H)	SEAT HEIGHT	DIMENSION (L x W x H)	SEAT HEIGHT
 29" x 15" x 27.5" (Junior)	14"	 37.7" x 15" x 35.75" (XL)	18.2"

### STEP 2: FULLY ZIPPERED

#### FULLY ZIPPERED



Fully Zippered (Z)

*\*Reference the product breakdown on back for availability.*

### STEP 3: GRADE AND TEXTILE

#### GRADES & SWATCHES



[CLICK TO VIEW »](#)

#### FABRIC DIRECTION & COLOR GUIDE



[CLICK TO VIEW »](#)

#### COLOR GUIDE

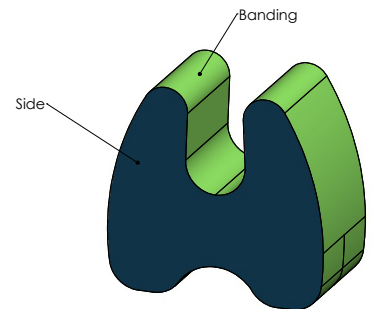

*\*Thread will default to match the seat textile.*

### STEP 4: ACCESSORIES (OPTIONAL)

#### EMBROIDERY

- Personalize your furniture with embroidery!
- We can embroider logos up to 12" x 15".

#### EMBROIDERY SPECS

[CLICK TO VIEW »](#)



#### CAL TB-133

- Optional flame retardant add on.

*\*Reference the product breakdown on back for availability.*



## STEP 5: CONFIGURE PART NUMBER

### FILL IN YOUR PART NUMBER

F	7	2	1	-	2	9	x	1	5	x	2	7	.5	-	Z		
FAMILY					STEP 1								STEP 2				
L				W				H				ZIP					

### EXAMPLE PART NUMBER

F	7	2	1	-	2	9	x	1	5	x	2	7	.5	-	Z		
FAMILY					STEP 1								STEP 2				
L				W				H				ZIP					

## STEP 6: CONFIGURE DESCRIPTION

### FILL IN YOUR DESCRIPTION

#### 1. BANDING

1. Banding					
LOCATION	GRADE	MANUFACTURER	PATTERN	COLOR	

#### 2. SIDE

2. Side					
LOCATION	GRADE	MANUFACTURER	PATTERN	COLOR	

STEP 3

#### EMBROIDERY\*

LOCATION	NAME

#### FLAME RETARDANT\*

--

### EXAMPLE DESCRIPTION

#### 1. BANDING

1. Banding	1	Spradling	Silvertex	Sage
LOCATION	GRADE	MANUFACTURER	PATTERN	COLOR

#### 2. SIDE

2. Side	3	Momentum	Tribeca	Fossil
LOCATION	GRADE	MANUFACTURER	PATTERN	COLOR

#### EMBROIDERY\*

Side	Rocket Logo
LOCATION	NAME

#### FLAME RETARDANT\*

CAL TB-133
------------

\*Optional add-ons. Reference product breakdown for availability.

INCLUDE ON PURCHASE ORDER

## EXAMPLE CONFIGURATION

F721-29x15x27.5-Z

1. Banding: Grade 1, Spradling, Silvertex, Sage | 2. Side: Grade 3, Momentum, Tribeca, Fossil

Embroidery: Side, Rocket logo | CAL TB-133

## PRODUCT BREAKDOWN

### HUG CHAIR (F721)

Product No.	Dimen./Weight (L x W x H)	FOOT OPTIONS											INTEGRATED POWER OPTIONS										TFL	Emb.
		Zip Z	Standard G1 L1		3" Premium R3 C3		6" Premium S16 S29 C6 T6 R6 M6				Standard G1 L1		3" Premium R3 C3		6" Premium S16 S29 C6 T6 R6 M6									
Junior F721-29x15x27.5	29" x 15" x 27.5" 8 lbs. (14" Seat Height)	✓	-	-	-	-	-	-	-	-	-	-	-	-	-	-	-	-	-	-	-	-	✓	
XL F721-37.7x15x35.75	37.7" x 15" x 35.75" 14 lbs. (18.2" Seat Height)	✓	-	-	-	-	-	-	-	-	-	-	-	-	-	-	-	-	-	-	-	-	✓	

**Fōmcore**  
SERVE. CREATE. INSPIRE.

1770 E. Keating Ave - Muskegon, MI 49442 • Tel: 231.366.4791 • [www.fomcore.com](http://www.fomcore.com)

ADDITIONAL  
RESOURCES



CLICK TO VIEW »