

## NEST SERIES

# EAGLE'S EGG PAD

Product No. F713

The Eagle's Egg Pad is a comfortable seating option for when sitting on the floor. The versatile piece can be used on its own or can be placed into the center of an Eagle's Nest to create a quiet space.

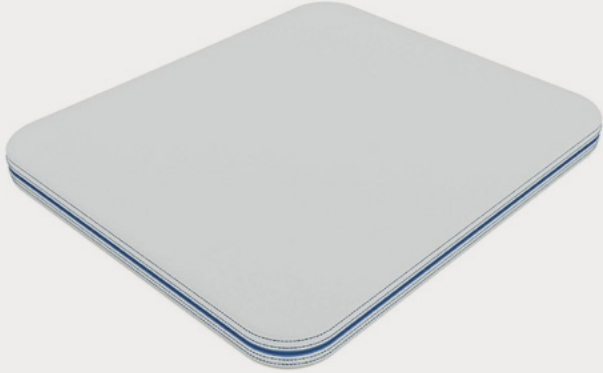

## DETAILS

### CONSTRUCTION

- Solid foam construction
- MDF baseboard to fit foot options
- Fully zippered (no wood base)
- Reinforced seams and stitching
- Made in USA
- Backed with a lifetime warranty

### MODIFICATION

- Textile and placement
- Colored stitching and zipper
- Embroidery

## QUICK COMBOS

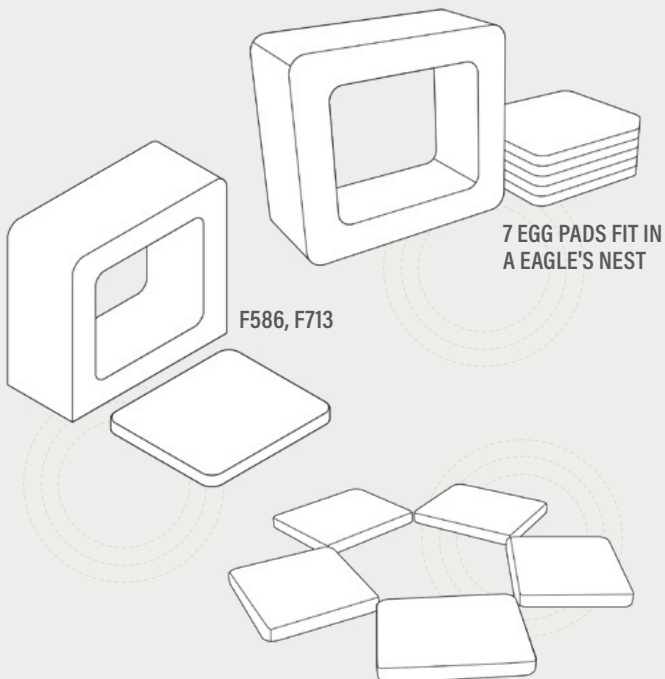

## HOW TO SPECIFY F713

### STEP 1: SEAT HEIGHT

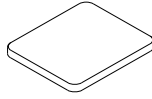
DIMENSION (LxWxH)	SEAT HEIGHT
 40" x 34.5"	3"

### STEP 2: FULLY ZIPPERED

#### FULLY ZIPPERED



Fully Zippered (Z)

*\*Reference the product breakdown on back for availability.*

### STEP 3: GRADE AND TEXTILE

#### GRADES & SWATCHES



[CLICK TO VIEW »](#)

#### ONE COLOR STANDARD

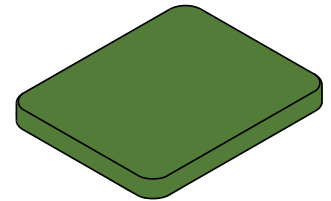

*\*Thread will default to match the seat textile.*

### STEP 4: ACCESSORIES (OPTIONAL)

#### EMBROIDERY

- Personalize your furniture with embroidery!
- We can embroider logos up to 12" x 15".

#### EMBROIDERY SPECS

[CLICK TO VIEW »](#)



#### CAL TB-133

- Optional flame retardant add on.

*\*Reference the product breakdown on back for availability.*

INCLUDE ON PURCHASE ORDER

## STEP 5: CONFIGURE PART NUMBER

### FILL IN YOUR PART NUMBER

F	7	1	3	-	4	0	x	3	4	.	5	x	3	-	Z		
FAMILY					STEP 1								STEP 2				
L					W				H				ZIP				

### EXAMPLE PART NUMBER

F	7	1	3	-	4	0	x	3	4	.	5	x	3	-	Z		
FAMILY					STEP 1								STEP 2				
L					W				H				ZIP				

## STEP 6: CONFIGURE DESCRIPTION

### FILL IN YOUR DESCRIPTION

#### 1. SEAT

1. Seat					
LOCATION	GRADE	MANUFACTURER	PATTERN	COLOR	

#### 2. SIDE

2. Side					
LOCATION	GRADE	MANUFACTURER	PATTERN	COLOR	

#### EMBROIDERY\*

LOCATION	NAME

#### FIRE RETARDANCY\*

--

STEP 3

### EXAMPLE DESCRIPTION

#### 1. SEAT

1. Seat	1	Spradling	Silvertex	Sage
LOCATION	GRADE	MANUFACTURER	PATTERN	COLOR

#### 2. SIDE

2. Side	3	Momentum	Tribeca	Fossil
LOCATION	GRADE	MANUFACTURER	PATTERN	COLOR

#### EMBROIDERY\*

Seat	Rocket Logo
LOCATION	NAME

#### FIRE RETARDANCY\*

CAL TB-133
------------

\*Optional add-ons. Reference product breakdown for availability.

### EXAMPLE CONFIGURATION

F713-40x34.5x3-Z

1. Seat: Grade 1, Spradling, Silvertex, Sage | 2. Side: Grade 3, Momentum, Tribeca, Fossil

Embroidery: Seat, Rocket logo | CAL TB-133

## PRODUCT BREAKDOWN

### EAGLE'S EGG PAD (F713)

Product No.	Dimen./Weight (L x W x H)	FOOT OPTIONS												INTEGRATED POWER OPTION								TFL	Emb.	
		Zip Z	Standard		3" Premium		6" Premium				Standard		3" Premium		6" Premium									
		G1	L1	R3	C3	S16	S29	C6	T6	R6	M6	G1	L1	R3	C3	S16	S29	C6	T6	R6	M6			
F713-40x34.5x3	40" x 34.5" x 3" 4 lbs.	✓	-	-	-	-	-	-	-	-	-	-	-	-	-	-	-	-	-	-	-	-	-	✓



1770 E. Keating Ave - Muskegon, MI 49442 • Tel: 231.366.4791 • [www.fomcore.com](http://www.fomcore.com)

ADDITIONAL RESOURCES



CLICK TO VIEW »