

## OTTOMAN & BENCH SERIES

# ROK DROP

Product No. F166

Our ROK Drop active seating solution is sure to be a hit with your active learners. Solid foam, single-cut construction guarantees that learners will be comfortable, safe, and free to move. The rounded base allows energized students to satisfy their urge to move without distracting their peers. The result is a more comfortable, attentive, and ready to learn student.



## DETAILS

### CONSTRUCTION

- Solid foam construction
- Reinforced seams and stitching
- Non-slip base
- Made in USA
- Backed with a lifetime warranty

### MODIFICATION

- Seat height
- Textile and placement
- Colored stitching
- Embroidery

## HOW TO SPECIFY F166

### STEP 1: SEAT HEIGHT

DIMENSION (DIA x H)	SEAT DIAMETER
 14" x 14"	13"

DIMENSION (DIA x H)	SEAT DIAMETER
 18" x 18"	16"

### STEP 2: FULLY ZIPPERED

#### FULLY ZIPPERED



Fully Zippered (Z)

*\*Reference the product breakdown on back for availability.*

### STEP 3: GRADE AND TEXTILE

#### GRADES & SWATCHES



[CLICK TO VIEW »](#)

#### FABRIC DIRECTION & COLOR GUIDE



[CLICK TO VIEW »](#)

#### COLOR GUIDE

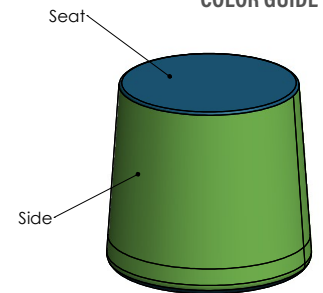

*\*Thread will default to match the seat textile.*

### STEP 4: ACCESSORIES (OPTIONAL)

#### EMBROIDERY

- Personalize your furniture with embroidery!
- We can embroider logos up to 12" x 15".

#### EMBROIDERY SPECS

[CLICK TO VIEW »](#)



#### CAL TB-133

- Optional flame retardant add on.

*\*Reference the product breakdown on back for availability.*



## STEP 5: CONFIGURE PART NUMBER

### FILL IN YOUR PART NUMBER

F	1	6	6	-		x		-	Z	
FAMILY					DIA		H		ZIP	
					STEP 1			STEP 2		

### EXAMPLE PART NUMBER

F	1	6	6	-	1	8	x	1	8	-	Z	
FAMILY					DIA		H	ZIP				

## STEP 6: CONFIGURE DESCRIPTION

### FILL IN YOUR DESCRIPTION

#### 1. SEAT

1. Seat				
LOCATION	GRADE	MANUFACTURER	PATTERN	COLOR

#### 2. SIDE

2. Side				
LOCATION	GRADE	MANUFACTURER	PATTERN	COLOR

#### EMBROIDERY\*

LOCATION	NAME

#### FIRE RETARDANCY\*

--

STEP 3

### EXAMPLE DESCRIPTION

#### 1. SEAT

1. Seat	1	Spradling	Silvertex	Sage
LOCATION	GRADE	MANUFACTURER	PATTERN	COLOR

#### 2. SIDE

2. Side	3	Momentum	Tribeca	Fossil
LOCATION	GRADE	MANUFACTURER	PATTERN	COLOR

#### EMBROIDERY\*

Seat	Rocket Logo
LOCATION	NAME

#### FIRE RETARDANCY\*

CAL TB-133
------------

\*Optional add-ons. Reference product breakdown for availability.

INCLUDE ON PURCHASE ORDER

## EXAMPLE CONFIGURATION

F166-18x18-Z

1. Seat: Grade 1, Spradling, Silvertex, Sage | 2. Side: Grade 3, Momentum, Tribeca, Fossil

Embroidery: Seat, Rocket logo | CAL TB-133h

## PRODUCT BREAKDOWN

### ROK DROP (F166)

Product No.	Dimen./Weight (Dia x H)	Zip Z	FOOT OPTIONS										INTEGRATED POWER OPTIONS						TFL	Emb.				
			Standard		3" Premium		6" Premium						Standard		3" Premium		6" Premium							
			G1	L1	R3	C3	S16	S29	C6	T6	R6	M6	G1	L1	R3	C3	S16	S29	C6	T6	R6	M6		
Small F166-14x14 (13" Seat Diameter)	14" x 14" 3 lbs.	✓	-	-	-	-	-	-	-	-	-	-	-	-	-	-	-	-	-	-	-	-	-	✓
Large F166-18x18 (16" Seat Diameter)	18" x 18" 6 lbs.	✓	-	-	-	-	-	-	-	-	-	-	-	-	-	-	-	-	-	-	-	-	-	✓



1770 E. Keating Ave - Muskegon, MI 49442 • Tel: 231.366.4791 • [www.fomcore.com](http://www.fomcore.com)

#### ADDITIONAL RESOURCES



[CLICK TO VIEW »](#)