

NETWORK SERIES

BOOMERANG SOFA

Product No. F123

With our light-weight, solid foam construction, you can maneuver the Boomerang Sofa into endless combinations. Meetings, gatherings, and even quick chats will flourish in your purposefully curated spaces. Showcasing the variety of geometry from the Boomerang Sofa, your creativity has no bounds to craft the proper environment for any situation.



DETAILS

CONSTRUCTION

- Solid foam construction
- MDF baseboard to fit foot options
- Reinforced seams and stitching
- Made in USA
- Backed with a lifetime warranty

MODIFICATION

- Textile and placement
- Leg, caster, and foot options
- Colored stitching
- Power
- Embroidery

QUICK COMBOS

F112, F113, F115, F123

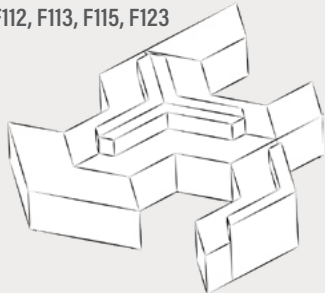

F115, F123, F113

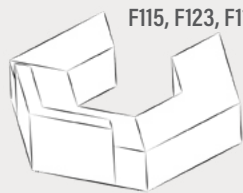

F123

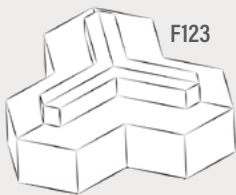

F112, F113, F115, F123

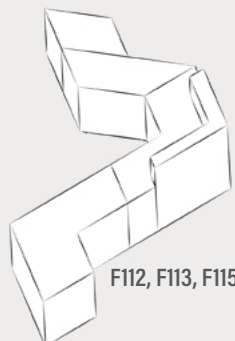

HOW TO SPECIFY F123

STEP 1: SEAT HEIGHT

DIMENSION (L x W)	SEAT HEIGHT
	16"

DIMENSION (L x W)	SEAT HEIGHT
	18"

STEP 2: FOOT

1" STANDARD FOOT OPTIONS

- Nylon Glide (G1)
- Felt Glide (G1)
- 1" Low Profile Leg (L1) Black
- 3" Caster (C3)

6" PREMIUM FOOT OPTIONS

- 6" Mod Leg (M6)
- 6" Caster (C6)

*Reference the product breakdown on back for availability.

STEP 3: GRADE AND TEXTILE

GRADES & SWATCHES



[CLICK TO VIEW »](#)

FABRIC DIRECTION & COLOR GUIDE



[CLICK TO VIEW »](#)

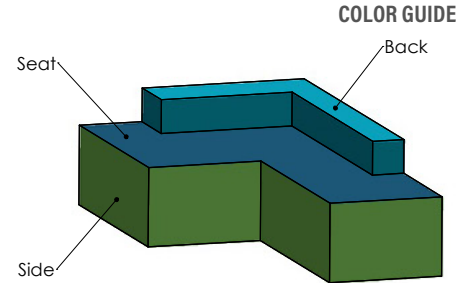

*Thread will default to match the seat textile.

STEP 4: ACCESSORIES (OPTIONAL)

INTEGRATED POWER OPTIONS* (PI, PI+)

- White
- Silver

PI = 1 Power Unit
PI+ = 2 Power Units

EMBROIDERY

- Personalize your furniture with embroidery!
- We can embroider logos up to 12" x 15".

EMBROIDERY SPECS

[CLICK TO VIEW »](#)



CAL TB-133

- Optional flame retardant add on.

*Reference the product breakdown on back for availability.

STEP 5: CONFIGURE PART NUMBER

FILL IN YOUR PART NUMBER

F	1	2	3	-	x	x	x	x	-					-					
FAMILY					STEP 1					STEP 2				STEP 4* (OPTIONAL)					
L				W				H				FOOT				POWER			

EXAMPLE PART NUMBER

F	1	2	3	-	7	2	x	1	8	x	2	5	-	M	6	-	P	1						
FAMILY					L				W				H				FOOT				POWER			

STEP 6: CONFIGURE DESCRIPTION

FILL IN YOUR DESCRIPTION

1. SEAT

1. Side					
LOCATION	GRADE	MANUFACTURER	PATTERN	COLOR	

2. SIDE

2. Seat					
LOCATION	GRADE	MANUFACTURER	PATTERN	COLOR	

3. BACK

3. Back					
LOCATION	GRADE	MANUFACTURER	PATTERN	COLOR	

FOOT

NAME/COLOR

POWER*

COLOR	QUANTITY
-------	----------

EMBROIDERY*

LOCATION	NAME
----------	------

FIRE RETARDANCY*

--

STEP 3

EXAMPLE DESCRIPTION

1. SEAT

1. Side	1	Spradling	Silvertex	Sage
LOCATION	GRADE	MANUFACTURER	PATTERN	COLOR

2. SIDE

2. Side	3	Momentum	Tribeca	Fossil
LOCATION	GRADE	MANUFACTURER	PATTERN	COLOR

3. BACK

3. Back	3	Momentum	Tribeca	Fossil
LOCATION	GRADE	MANUFACTURER	PATTERN	COLOR

FOOT

6" Mod Leg		POWER*
NAME/COLOR	White	COLOR
	1	QUANTITY

EMBROIDERY*

Seat	Rocket Logo
LOCATION	NAME

FIRE RETARDANCY*

CAL TB-133

*Optional add-ons. Reference product breakdown for availability.

INCLUDE ON PURCHASE ORDER

EXAMPLE CONFIGURATION

F123-72x18x25-M6-PI

1. Seat: Grade 1, Spradling, Silvertex, Sage | 2. Side: Grade 3, Momentum, Tribeca, Fossil | 3. Back: Grade 3, Momentum, Tribeca, Fossil

Foot: 6" Mod Leg | Power: White, Quantity: 1 | TFL Worksurface: White Wood | Embroidery: Seat, Rocket logo | CAL TB-133

PRODUCT BREAKDOWN

BOOMERANG SOFA (F123)

Product No.	Dimen./Weight (L x W x H)	FOOT OPTIONS										INTEGRATED POWER OPTION						TFL	Emb.						
		Zip		Standard		3" Premium		6" Premium				Standard		3" Premium		6" Premium									
		Z	G1	L1	R3	C3	S16	S29	C6	T6	R6	M6	G1	L1	R3	C3	S16			S29	C6	T6	R6	M6	
F123-72x18x23	72" x 18" x 23" 35 lbs. (16" Seat Height)	-	✓	✓	-	✓	-	-	✓	-	-	✓	✓	✓	-	✓	-	-	-	-	-	-	-	-	✓
F123-72x18x25	72" x 18" x 25" 37 lbs. (18" Seat Height)	-	✓	✓	-	✓	-	-	✓	-	-	✓	✓	✓	-	✓	-	-	✓	-	-	✓	-	-	✓



1770 E. Keating Ave - Muskegon, MI 49442 • Tel: 231.366.4791 • www.fomcore.com

ADDITIONAL RESOURCES



CLICK TO VIEW »