

NETWORK SERIES

BOOMERANG BENCH

Product No. F113

With our light-weight, solid foam construction, you can maneuver the Boomerang Bench into endless combinations. Meetings, gatherings, and even quick chats will flourish in your purposefully curated spaces. Showcasing the variety of geometry from the Boomerang Bench, your creativity has no bounds to craft the proper environment for any situation.



DETAILS

CONSTRUCTION

- Solid foam construction
- Reinforced seams and stitching
- MDF Baseboard to fit foot options
- Made in USA
- Backed with a lifetime warranty

MODIFICATION

- Textile and placement
- Leg, caster, and foot options
- Colored stitching
- Power
- Embroidery

QUICK COMBOS

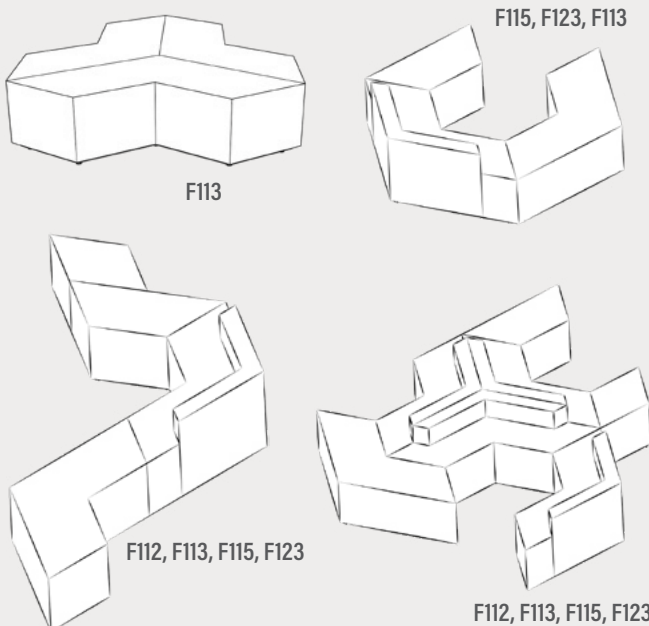

HOW TO SPECIFY F113

STEP 1: SEAT HEIGHT

DIMENSION (L x W)	SEAT HEIGHT
	16"
	18"

STEP 2: FOOT

1" STANDARD FOOT OPTIONS

- Nylon Glide (G1)
- Felt Glide (G1)
- 1" Low Profile Leg (L1)
Black
- 3" Caster (C3)

6" PREMIUM FOOT OPTIONS

- 6" Mod Leg (M6)
- 6" Caster (C6)

**Reference the product breakdown on back for availability.*

STEP 3: GRADE AND TEXTILE

GRADES & SWATCHES



[CLICK TO VIEW »](#)

FABRIC DIRECTION & COLOR GUIDE



[CLICK TO VIEW »](#)

COLOR GUIDE

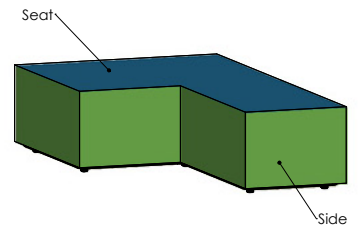

**Thread will default to match the seat textile.*

STEP 4: ACCESSORIES (OPTIONAL)

INTEGRATED POWER OPTIONS* (PI, PI+)

- White
- Silver
- PI = 1 Power Unit
- PI+ = 2 Power Units

EMBROIDERY

- Personalize your furniture with embroidery!
- We can embroider logos up to 12" x 15".

EMBROIDERY SPECS

[CLICK TO VIEW »](#)



CAL TB-133

- Optional flame retardant add on.

**Reference the product breakdown on back for availability.*

STEP 5: CONFIGURE PART NUMBER

FILL IN YOUR PART NUMBER

F	1	1	3	-	x	x	-			-		
FAMILY					STEP 1			FOOT			POWER	
											STEP 4* (OPTIONAL)	

EXAMPLE PART NUMBER

F	1	1	3	-	7	2	x	1	8	x	1	8	-	M	6	-	P	1
FAMILY					L		W		H		FOOT			POWER				

STEP 6: CONFIGURE DESCRIPTION

FILL IN YOUR DESCRIPTION

1. SEAT

1. Seat					
LOCATION	GRADE	MANUFACTURER	PATTERN	COLOR	

2. SIDE

2. Side					
LOCATION	GRADE	MANUFACTURER	PATTERN	COLOR	

FOOT

NAME/COLOR

POWER*

COLOR	QUANTITY
-------	----------

EMBROIDERY*

LOCATION	NAME
----------	------

FIRE RETARDANCY*

--

STEP 3

EXAMPLE DESCRIPTION

1. SEAT

1. Seat	1	Spradling	Silvertex	Sage
LOCATION	GRADE	MANUFACTURER	PATTERN	COLOR

2. SIDE

2. Side	3	Momentum	Tribeca	Fossil
LOCATION	GRADE	MANUFACTURER	PATTERN	COLOR

FOOT

6" Mod Leg

POWER*

White	1
COLOR	QUANTITY

EMBROIDERY*

Seat	Rocket Logo
LOCATION	NAME

FIRE RETARDANCY*

CAL TB-133

*Optional add-ons. Reference product breakdown for availability.

INCLUDE ON PURCHASE ORDER

EXAMPLE CONFIGURATION

F113-72x18x18-M6-PI

1. Seat: Grade 1, Spradling, Silvertex, Sage | 2. Side: Grade 3, Momentum, Tribeca, Fossil

Foot: 6" Mod Leg | Power: White, Quantity: 1 | Embroidery: Seat, Rocket logo | CAL TB-133

PRODUCT BREAKDOWN

BOOMERANG BENCH (F113)

Product No.	Dimen./Weight (L x W x H)	FOOT OPTIONS												INTEGRATED POWER OPTION								TFL	Emb.		
		Zip Z	Standard		3" Premium		6" Premium				Standard		3" Premium		6" Premium										
			G1	L1	R3	C3	S16	S29	C6	T6	R6	M6	G1	L1	R3	C3	S16	S29	C6	T6	R6			M6	
F113-72x18x16	72" x 18" x 16" 32 lbs.	-	✓	✓	-	✓	-	-	✓	-	-	✓	✓	✓	-	✓	-	-	-	-	-	-	-	-	✓
F113-72x18x18	72" x 18" x 18" 34 lbs.	-	✓	✓	-	✓	-	-	✓	-	-	✓	✓	✓	-	✓	-	-	✓	-	-	✓	-	✓	✓

Fōmcore
SERVE. CREATE. INSPIRE.

1770 E. Keating Ave - Muskegon, MI 49442 • Tel: 231.366.4791 • www.fomcore.com

ADDITIONAL
RESOURCES



CLICK TO VIEW »