

# STEP SERIES THREE STEP

Product No. F028

This finely crafted foam step is built to impress. Since the Three Step is made of solid foam, it's light and convenient to move around and NO HARD EDGES, making it safe for learners of any age. With the entire STEP line you can fit them together for collaboration, tiered seating, or even small groups by simply shifting them around. The Step Series is a wonderful seating solution in transition spaces like, hallways and entry areas. Create a unique seating space in the center of a room or push them against a wall in any combination.

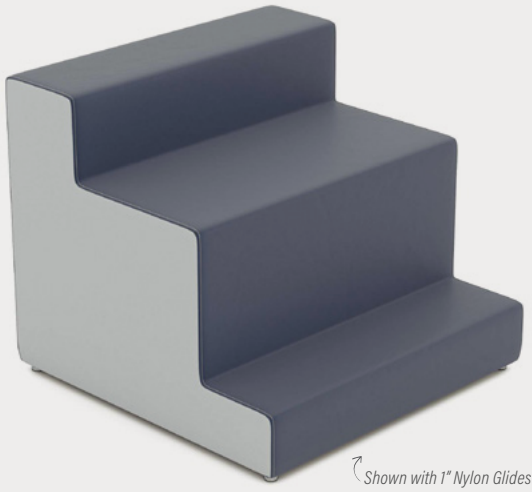

Shown with 1" Nylon Glides

## DETAILS

### CONSTRUCTION

- Solid foam construction
- Reinforced seams and stitching
- MDF Baseboard to fit foot options
- Made in USA
- Backed with a lifetime warranty

### MODIFICATION

- Textile and placement
- Leg and foot options
- Colored stitching
- Power
- Embroidery

## QUICK COMBOS

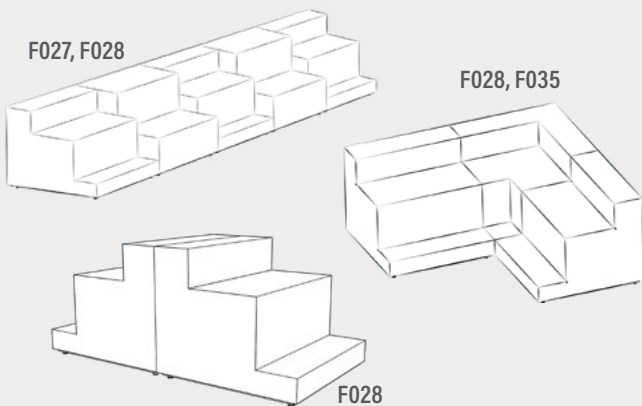

# HOW TO SPECIFY F028

## STEP 1: HEIGHT

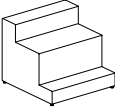
DIMENSION (L x W)	HEIGHT	STEP 1 HEIGHT	STEP 2 HEIGHT
 38" x 38"	32"	7"	23"

## STEP 2: FOOT

### 1" STANDARD FOOT OPTIONS

-  Nylon Glide (G1)
-  Felt Glide (G1)
-  1" Low Profile Leg (L1)  
Black

\*Reference the product breakdown on back for availability.

## STEP 3: GRADE AND TEXTILE

### GRADES & SWATCHES



[CLICK TO VIEW »](#)

### FABRIC DIRECTON & COLOR GUIDE



[CLICK TO VIEW »](#)

### COLOR GUIDE

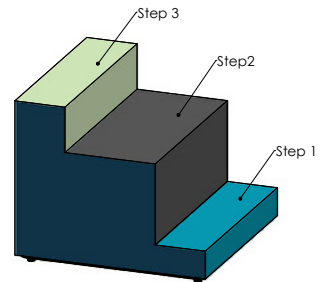

\*Thread will default to match the seat textile.

## STEP 4: ACCESSORIES (OPTIONAL)

### INTEGRATED POWER OPTIONS\* (PI, PI+)

-  White
-  Silver

PI = 1 Power Unit  
PI+ = 2 Power Units

### EMBROIDERY

- Personalize your furniture with embroidery!
- We can embroider logos up to 12" x 15".

### EMBROIDERY SPECS

[CLICK TO VIEW »](#)



### CAL TB-133

- Optional flame retardant add on.

\*Reference the product breakdown on back for availability.

## STEP 5: CONFIGURE PART NUMBER

### FILL IN YOUR PART NUMBER

F	0	2	8	-	3	8	x	3	8	x	3	2	-				-					
FAMILY					L				W				H				FOOT			POWER		
STEP 1												STEP 2			STEP 4* (OPTIONAL)							

### EXAMPLE PART NUMBER

F	0	2	8	-	3	8	x	3	8	x	3	2	-	G	1	-	P	1		
FAMILY					L				W				H				FOOT		POWER	

## STEP 6: CONFIGURE DESCRIPTION

### FILL IN YOUR DESCRIPTION

#### 1. SIDE

1. Side				
LOCATION	GRADE	MANUFACTURER	PATTERN	COLOR

#### 2. BACK

2. Back				
LOCATION	GRADE	MANUFACTURER	PATTERN	COLOR

#### 3. STEP 1

3. Step 1				
LOCATION	GRADE	MANUFACTURER	PATTERN	COLOR

#### 4. STEP 2

4. Step 2				
LOCATION	GRADE	MANUFACTURER	PATTERN	COLOR

#### FOOT

NAME/COLOR

#### POWER\*

COLOR	QUANTITY

#### EMBROIDERY\*

LOCATION	NAME

#### FLAME RETARDANT\*

--

STEP 3

### EXAMPLE DESCRIPTION

#### 1. SIDE

1. Side	1	Spradling	Silvertex	Sage
LOCATION	GRADE	MANUFACTURER	PATTERN	COLOR

#### 2. BACK

2. Back	3	Momentum	Tribeca	Fossil
LOCATION	GRADE	MANUFACTURER	PATTERN	COLOR

#### 3. STEP-1

3. Step 1	3	Momentum	Tribeca	Fossil
LOCATION	GRADE	MANUFACTURER	PATTERN	COLOR

#### 4. STEP-2

4. Step 2	3	Momentum	Tribeca	Fossil
LOCATION	GRADE	MANUFACTURER	PATTERN	COLOR

#### FOOT

1" Nylon Glide
NAME/COLOR

#### POWER\*

White	1
COLOR	QUANTITY

#### EMBROIDERY\*

Seat	Rocket Logo
LOCATION	NAME

#### FLAME RETARDANT\*

CAL TB-133
------------

\*Optional add-ons. Reference product breakdown for availability.

INCLUDE ON PURCHASE ORDER

## EXAMPLE CONFIGURATION

F028-38x38x32-G1-PI

1. Side: Grade 1, Spradling, Silvertex, Sage | 2. Back: Grade 3, Momentum, Tribeca, Fossil  
 3. Step 1: Grade 3, Momentum, Tribeca, Fossil | 4. Step 2: Grade 3, Momentum, Tribeca, Fossil  
 Foot: 1" Nylon Glide | Power: White, Quantity: 1 | Embroidery: Seat, Rocket logo | CAL TB-133

## PRODUCT BREAKDOWN

### THREE STEP (F028)

Product No.	Dimen./Weight (L x W x H)	FOOT OPTIONS												INTEGRATED POWER OPTION						TFL	Emb.				
		Zip	Standard		3" Premium		6" Premium				Standard		3" Premium		6" Premium										
		Z	G1	L1	R3	C3	S16	S29	C6	T6	R6	M6	G1	L1	R3	C3	S16	S29	C6			T6	R6	M6	
F028-38x38x32	38" x 38" x 32" 48 lbs.	-	✓	✓	-	-	-	-	-	-	-	-	✓	✓	-	-	-	-	-	-	-	-	-	-	✓



1770 E. Keating Ave - Muskegon, MI 49442 • Tel: 231.366.4791 • [www.fomcore.com](http://www.fomcore.com)

ADDITIONAL RESOURCES



CLICK TO VIEW »