

STEP SERIES TWO STEP

Product No. F027

This finely crafted foam step is built to impress. Since the Two Step is made of solid foam, it's light and convenient to move around and NO HARD EDGES, making it safe for learners of any age. With the entire STEP line you can fit them together for collaboration, tiered seating, or even small groups by simply shifting them around. The Step Series is a wonderful seating solution in transition spaces like, hallways and entry areas. Create a unique seating space in the center of a room or push them against a wall in any combination.



Shown with 1" Nylon Glides

DETAILS

CONSTRUCTION

- Solid foam construction
- MDF baseboard to fit foot options
- Reinforced seams and stitching
- Made in USA
- Backed with a lifetime warranty

MODIFICATION

- Textile and placement
- Leg and foot options
- Colored stitching
- Power
- Embroidery

QUICK COMBOS

F027, F030, F029



F027

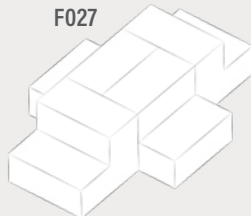

F027, F028

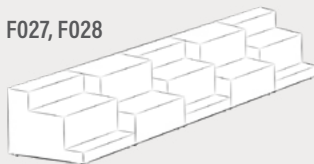

F027, F029

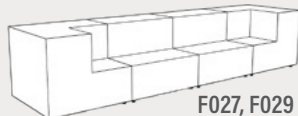

HOW TO SPECIFY F027

STEP 1: HEIGHT

DIMENSION (L x W)	HEIGHT	STEP HEIGHT
38" x 38"	32"	16.5"

STEP 2: FOOT

1" STANDARD FOOT OPTIONS

- Nylon Glide (G1)
- Felt Glide (G1)
- 1" Low Profile Leg (L1)
Black

*Reference the product breakdown on back for availability.

STEP 3: GRADE AND TEXTILE

GRADES & SWATCHES



[CLICK TO VIEW »](#)

FABRIC DIRECTON & COLOR GUIDE



[CLICK TO VIEW »](#)

COLOR GUIDE

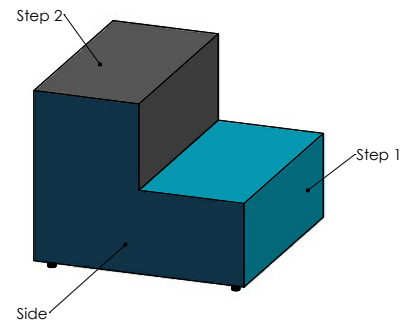

*Thread will default to match the seat textile.

STEP 4: ACCESSORIES (OPTIONAL)

INTEGRATED POWER OPTIONS* (PI, PI+)

- White
- Silver

PI = 1 Power Unit
PI+ = 2 Power Units

EMBROIDERY

- Personalize your furniture with embroidery!
- We can embroider logos up to 12" x 15".

EMBROIDERY SPECS

[CLICK TO VIEW »](#)



CAL TB-133

- Optional flame retardant add on.

*Reference the product breakdown on back for availability.

STEP 5: CONFIGURE PART NUMBER

FILL IN YOUR PART NUMBER

F	0	2	7	-	3	8	x	3	8	x	3	2	-				-					
FAMILY					L				W				H				FOOT			POWER		
STEP 1												STEP 2			STEP 3* (OPTIONAL)							

EXAMPLE PART NUMBER

F	0	2	7	-	3	8	x	3	8	x	3	2	-	G	1	-	P	I		
FAMILY					L				W				H				FOOT		POWER	

STEP 6: CONFIGURE DESCRIPTION

FILL IN YOUR DESCRIPTION

1. SIDE					STEP 3
1. Side					
LOCATION	GRADE	MANUFACTURER	PATTERN	COLOR	
2. BACK					
2. Back					
LOCATION	GRADE	MANUFACTURER	PATTERN	COLOR	
3. STEP-1					
2. Step 1					
LOCATION	GRADE	MANUFACTURER	PATTERN	COLOR	
4. STEP-2					
2. Step 2					
LOCATION	GRADE	MANUFACTURER	PATTERN	COLOR	
FOOT		POWER*			
1" Nylon Glide		White 1			
NAME/COLOR		COLOR QUANTITY			
EMBROIDERY*					
Seat Rocket Logo					
LOCATION NAME					

EXAMPLE DESCRIPTION

1. SIDE				
1. Side	1	Spradling	Silvertex	Sage
LOCATION	GRADE	MANUFACTURER	PATTERN	COLOR
2. BACK				
2. Back	3	Momentum	Tribeca	Fossil
LOCATION	GRADE	MANUFACTURER	PATTERN	COLOR
3. STEP-1				
2. Step 1	3	Momentum	Tribeca	Fossil
LOCATION	GRADE	MANUFACTURER	PATTERN	COLOR
4. STEP-2				
2. Step 2	3	Momentum	Tribeca	Fossil
LOCATION	GRADE	MANUFACTURER	PATTERN	COLOR
FOOT		POWER*		
1" Nylon Glide		White 1		
NAME/COLOR		COLOR QUANTITY		
EMBROIDERY*				
Seat Rocket Logo				
LOCATION NAME				

*Optional add-ons. Reference product breakdown for availability.

INCLUDE-ON PURCHASE ORDER

EXAMPLE CONFIGURATION

F027-38x38x32-G1-PI

1. Seat: Grade 1, Spradling, Silvertex, Sage | 2. Back: Grade 3, Momentum, Tribeca, Fossil
 2. Step -1: Grade 3, Momentum, Tribeca, Fossil | 2. Step-2: Grade 3, Momentum, Tribeca, Fossil | Foot: 1" Nylon Glide
 | Power: White, Quantity: 1 | Embroidery: Seat, Rocket logo

PRODUCT BREAKDOWN

TWO STEP (F027)

Product No.	Dimen./Weight (L x W x H)	Zip Z	FOOT OPTIONS												INTEGRATED POWER OPTION												TFL	Emb.
			Standard		3" Premium		6" Premium				Standard		3" Premium		6" Premium													
			G1	L1	R3	C3	S16	S29	C6	T6	R6	M6	G1	L1	R3	C3	S16	S29	C6	T6	R6	M6						
F027-38x38x32	38" x 38" x 32" 52 lbs.	-	✓	✓	-	-	-	-	-	-	-	-	✓	✓	-	-	-	-	-	-	-	-	-	-	✓			



1770 E. Keating Ave - Muskegon, MI 49442 • Tel: 231.366.4791 • www.fomcore.com

ADDITIONAL RESOURCES



[CLICK TO VIEW »](#)