

OTTOMAN & BENCH SERIES AMOEBIA BENCH

Product No. F006

With its organic, fun and creative shape, the Amoeba is a perfect piece to inspire in media centers or in the classroom. Pull up a few ROK Ottomans and turn this Amoeba into a collaborative active seating space where students can share ideas and explore their creativity. Add more Amoebas to your space to create break-out pods that allow students smaller group interaction. However you utilize the Amoeba it will be sure to bring fun and collaboration to your learning environment.



DETAILS

CONSTRUCTION

- Solid foam construction
- Reinforced seams and stitching
- MDF baseboard to fit foot options
- Made in USA
- Backed with a lifetime warranty

MODIFICATION

- Seat height
- Textile and placement
- Leg, caster, and foot options
- Colored stitching
- TFL work surface
- Embroidery

QUICK COMBOS



Fōmcore
SERVE. CREATE. INSPIRE.

HOW TO SPECIFY F006

STEP 1: SEAT HEIGHT

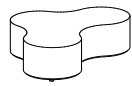
DIMENSION (L x W)	SEAT HEIGHT
 48" x 33.5"	14"
	16"
	18"
	20"

STEP 2: FOOT

1" STANDARD FOOT OPTIONS

-  Nylon Glide (G1)
-  Felt Glide (G1)
- 1" Low Profile Leg (L1)
Black

6" PREMIUM FOOT OPTIONS

- 6" Mod Leg (M6)
- 6" Rectangle (R6)
Black
- 6" Rectangle (R6)
Silver
- 6" Triangle (T6)
Black
- 6" Triangle (T6)
Silver
- 6" Caster (C6)

3" PREMIUM FOOT OPTIONS

- 3" Rectangle (R3)
Black
- 3" Rectangle (R3)
Silver
- 3" Caster (C3)

*Reference the product breakdown on back for availability.

STEP 3: GRADE AND TEXTILE

GRADES & SWATCHES



[CLICK TO VIEW »](#)

FABRIC DIRECTION & COLOR GUIDE



[CLICK TO VIEW »](#)



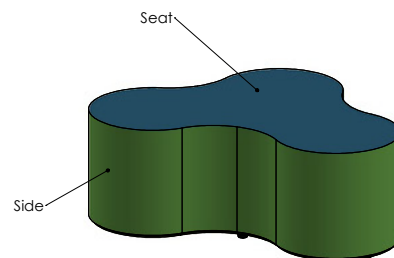

COLOR GUIDE



*Thread will default to match the seat textile.

STEP 4: ACCESSORIES (OPTIONAL)

TFL WORKSURFACE (TFL)

-  White Wood
-  Natural Maple
-  Dark Wood
-  Black Crystal
-  Fashion Grey
-  Marker Board

EMBROIDERY

- Personalize your furniture with embroidery!
- We can embroider logos up to 12" x 15".

EMBROIDERY SPECS

[CLICK TO VIEW »](#)



CAL TB-133

- Optional flame retardant add on.

*Reference the product breakdown on back for availability.

STEP 5: CONFIGURE PART NUMBER

FILL IN YOUR PART NUMBER

F	0	0	6	-		x			x		-				-			
FAMILY					STEP 1						STEP 2			STEP 4* (OPTIONAL)				
L				W			H			FOOT			TFL					

EXAMPLE PART NUMBER

F	0	0	6	-	4	8	x	3	3	.5	x	1	8	-	R	6	-	T	F	L		
FAMILY					L						W			H			FOOT			TFL		

STEP 6: CONFIGURE DESCRIPTION

FILL IN YOUR DESCRIPTION

1. SEAT

1. Seat				
LOCATION	GRADE	MANUFACTURER	PATTERN	COLOR

2. SIDE

2. Side				
LOCATION	GRADE	MANUFACTURER	PATTERN	COLOR

FOOT

NAME/COLOR

FIRE RETARDANCY*

--

TFL WORKSURFACE*

COLOR

EMBROIDERY*

LOCATION	NAME
----------	------

EXAMPLE DESCRIPTION

1. SEAT

1. Seat	1	Spradling	Silvertex	Neutra
LOCATION	GRADE	MANUFACTURER	PATTERN	COLOR

2. SIDE

2. Side	3	Momentum	Tribeca	Slate
LOCATION	GRADE	MANUFACTURER	PATTERN	COLOR

FOOT

6" Rectangle Leg - Black

NAME/COLOR

TFL WORKSURFACE*

White Wood

EMBROIDERY*

Seat	Rocket Logo
------	-------------

COLOR

CAL TB-133

FIRE RETARDANCY*

CAL TB-133

*Optional add-ons. Reference product breakdown for availability.

INCLUDE ON PURCHASE ORDER

EXAMPLE CONFIGURATION

F006-48x33.5x18-R6-TFL

1. Seat: Grade 1, Spradling, Silvertex, Sage | 2. Side: Grade 3, Momentum, Tribeca, Fossil

Foot: 6" Rectangle Leg Black | TFL Worksurface: White Wood | Embroidery: Seat, Rocket logo | CAL TB-133

PRODUCT BREAKDOWN

AMOEBIA BENCH (F006)

Product No.	Dimen./Weight (L x W x H)	Zip Z	FOOT OPTIONS										INTEGRATED POWER OPTION						TFL	Emb.			
			Standard		3" Premium		6" Premium						Standard		3" Premium		6" Premium						
			G1	L1	R3	C3	S16	S29	C6	T6	R6	M6	G1	L1	R3	C3	S16	S29			C6	T6	R6
F006-48x33.5x14	48" x 33.5" x 14" 27 lbs.	-	✓	✓	✓	✓	-	-	✓	✓	✓	✓	-	-	-	-	-	-	-	-	-	✓	✓
F006-48x33.5x16	48" x 33.5" x 16" 29 lbs.	-	✓	✓	✓	✓	-	-	✓	✓	✓	✓	-	-	-	-	-	-	-	-	-	✓	✓
F006-48x33.5x18	48" x 33.5" x 18" 30 lbs.	-	✓	✓	✓	✓	-	-	✓	✓	✓	✓	-	-	-	-	-	-	-	-	-	✓	✓
F006-48x33.5x20	48" x 33.5" x 20" 31 lbs.	-	✓	✓	✓	✓	-	-	✓	✓	✓	✓	-	-	-	-	-	-	-	-	-	✓	✓



1770 E. Keating Ave - Muskegon, MI 49442 • Tel: 231.366.4791 • www.fomcore.com

ADDITIONAL RESOURCES



CLICK TO VIEW »