

OTTOMAN & BENCH SERIES CRESCENT OTTOMAN

Product No. F003

The crescent shape of this ottoman is a conversation starter. If you're looking for a simple way to add extra seating and character to a room without sacrificing design, this is a piece you can't ignore. Relax into it as a footstool or a seat.



Shown with 1" Nylon Glides

DETAILS

CONSTRUCTION

- Solid foam construction
- Reinforced seams and stitching
- MDF baseboard to fit foot options
- Made in USA
- Backed with a lifetime warranty

MODIFICATION

- Seat height
- Textile and placement
- Leg and foot options
- Fully zippered (no wood base)
- Colored stitching and zipper
- TFL work surface
- Embroidery

WEATHER RESISTANT
See series page for more details. »



QUICK COMBOS

F052, F053, F051, F003

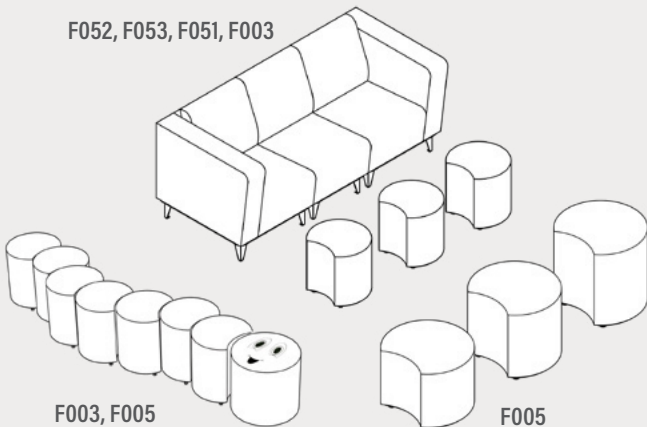

HOW TO SPECIFY F003

STEP 1: SEAT HEIGHT

| DIMENSION (DIA) | SEAT HEIGHT |
|-----------------|-------------|
| 18" | 12" |
| | 14" |
| | 16" |
| | 18" |
| | 20" |

STEP 2: FOOT AND FULLY ZIPPERED

FULLY ZIPPERED



1" STANDARD FOOT OPTIONS



3" PREMIUM FOOT OPTIONS

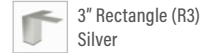
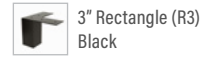

6" PREMIUM FOOT OPTIONS



*Reference the product breakdown on back for availability.

STEP 3: GRADE AND TEXTILE

GRADES & SWATCHES



CLICK TO VIEW »

FABRIC DIRECTION & COLOR GUIDE



CLICK TO VIEW »

COLOR GUIDE

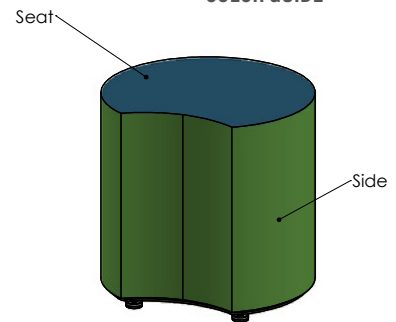

*Thread will default to match the seat textile.

STEP 4: ACCESSORIES (OPTIONAL)

TFL WORKSURFACE (TFL)

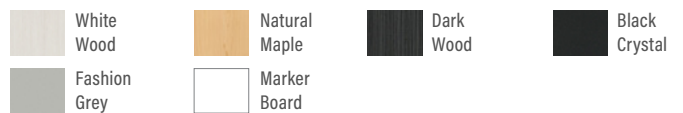

EMBROIDERY

- Personalize your furniture with embroidery!
- We can embroider logos up to 12" x 15".

EMBROIDERY SPECS

CLICK TO VIEW »



CAL TB-133

- Optional flame retardant add on.

*Reference the product breakdown on back for availability.

STEP 5: CONFIGURE PART NUMBER

FILL IN YOUR PART NUMBER

| | | | | | | | | | | | | | | | | |
|--------|---|---|---|---|--------|---|---|--------|----------|--|--------------------|-----|--|--|--|--|
| F | 0 | 0 | 3 | - | | x | | - | | | | - | | | | |
| FAMILY | | | | | DIA | | H | | FOOT/ZIP | | | TFL | | | | |
| | | | | | STEP 1 | | | STEP 2 | | | STEP 4* (OPTIONAL) | | | | | |

EXAMPLE PART NUMBER

| | | | | | | | | | | | | | | | | |
|--------|---|---|---|---|-----|---|---|----------|---|---|-----|---|---|---|---|---|
| F | 0 | 0 | 3 | - | 1 | 8 | x | 1 | 8 | - | R | 6 | - | T | F | L |
| FAMILY | | | | | DIA | | H | FOOT/ZIP | | | TFL | | | | | |

STEP 6: CONFIGURE DESCRIPTION

FILL IN YOUR DESCRIPTION

1. SEAT

| | | | | | |
|----------|-------|--------------|---------|-------|--|
| 1. Seat | | | | | |
| LOCATION | GRADE | MANUFACTURER | PATTERN | COLOR | |

2. SIDE

| | | | | | |
|----------|-------|--------------|---------|-------|--|
| 2. Side | | | | | |
| LOCATION | GRADE | MANUFACTURER | PATTERN | COLOR | |

FOOT

| |
|------------|
| NAME/COLOR |
|------------|

FIRE RETARDANCY*

| |
|--|
| |
|--|

TFL WORKSURFACE*

| |
|-------|
| COLOR |
|-------|

EMBROIDERY*

| | |
|----------|------|
| LOCATION | NAME |
|----------|------|

STEP 3

EXAMPLE DESCRIPTION

1. SEAT

| | | | | |
|----------|-------|--------------|-----------|-------|
| 1. Seat | 1 | Spradling | Silvertex | Sage |
| LOCATION | GRADE | MANUFACTURER | PATTERN | COLOR |

2. SIDE

| | | | | |
|----------|-------|--------------|---------|--------|
| 2. Side | 3 | Momentum | Tribeca | Fossil |
| LOCATION | GRADE | MANUFACTURER | PATTERN | COLOR |

FOOT

| |
|--------------------------|
| 6" Rectangle Leg - Black |
|--------------------------|

FIRE RETARDANCY*

| |
|------------|
| CAL TB-133 |
|------------|

NAME/COLOR

TFL WORKSURFACE*

| |
|------------|
| White Wood |
|------------|

EMBROIDERY*

| | |
|------|-------------|
| Seat | Rocket Logo |
|------|-------------|

COLOR

LOCATION

NAME

*Optional add-ons. Reference product breakdown for availability.

INCLUDE ON PURCHASE ORDER

EXAMPLE CONFIGURATION

F003-18x18-R6-TFL

1. Seat: Grade 1, Spradling, Silvertex, Sage | 2. Side: Grade 3, Momentum, Tribeca, Fossil

Foot: 6" Rectangle Leg Black | TFL Worksurface: White Wood | Embroidery: Seat, Rocket logo | CAL TB-133

PRODUCT BREAKDOWN

CRESCENT OTTOMAN (F003)

| Product No. | Dimen./Weight (L x W x H) | FOOT OPTIONS | | | | | | | | | | | INTEGRATED POWER OPTION | | | | | | | | | | TFL | Emb. |
|-------------|------------------------------|--------------|----------|----|------------|----|------------|-----|----|----|----------|----|-------------------------|----|------------|----|-----|-----|----|----|----|----|-----|------|
| | | Zip Z | Standard | | 3" Premium | | 6" Premium | | | | Standard | | 3" Premium | | 6" Premium | | | | | | | | | |
| | | | GI | L1 | R3 | C3 | S16 | S29 | C6 | T6 | R6 | M6 | GI | L1 | R3 | C3 | S16 | S29 | C6 | T6 | R6 | M6 | | |
| F003-18x12 | 18" x 12" 7 lbs. | ✓ | ✓ | ✓ | ✓ | - | - | - | - | - | ✓ | ✓ | - | - | - | - | - | - | - | - | - | - | ✓ | ✓ |
| F003-18x14 | 18" x 14" 8 lbs. | ✓ | ✓ | ✓ | ✓ | - | - | - | - | - | ✓ | ✓ | - | - | - | - | - | - | - | - | - | - | ✓ | ✓ |
| F003-18x16 | 18" x 16" 9 lbs. | ✓ | ✓ | ✓ | ✓ | - | - | - | - | - | ✓ | ✓ | - | - | - | - | - | - | - | - | - | - | ✓ | ✓ |
| F003-18x18 | 18" x 18" 10 lbs. | ✓ | ✓ | ✓ | ✓ | - | - | - | - | - | ✓ | ✓ | - | - | - | - | - | - | - | - | - | - | ✓ | ✓ |
| F003-18x20 | 18" x 20" 11 lbs. | ✓ | ✓ | ✓ | ✓ | - | - | - | - | - | ✓ | ✓ | - | - | - | - | - | - | - | - | - | - | ✓ | ✓ |



1770 E. Keating Ave - Muskegon, MI 49442 • Tel: 231.366.4791 • www.fomcore.com

ADDITIONAL RESOURCES



CLICK TO VIEW »