

LOTUS SERIES | SENSORY AND SAFE HUG CHAIR 2.0

Product No. FK034

Sometimes, we all need a hug to feel better. The Hug Chair 2.0 mimics the original design of our Hug Chair with a few changes. When a student sits in the chair, the inverted arms create a light, calming reassurance. The rounded outside profile supports their arms hanging down, and the widened base allows for free movement of the hips. The Hug Chair 2.0 gives students an opportunity to self-regulate and keep the environment safe.



DETAILS

CONSTRUCTION

- Solid foam construction
- Reinforced seams and stitching
- Fully zippered (no wood base)
- Made in USA
- Backed with a lifetime warranty
- No pinch points



MODIFICATION

- Textile & placement
- ✔ Non-skid base available
- Colored stitching and zipper
- Embroidery



HOW TO SPECIFY FK034

STEP 1: HEIGHT

DIMENSION (L x W x H)	SEAT HEIGHT	DIMENSION (L x W x H)	SEAT HEIGHT
 30" x 15" x 28.5" (Junior)	15"	 35" x 15" x 30.5" (XL)	17"

STEP 2: FULLY ZIPPERED

FULLY ZIPPERED



Fully Zippered (Z)

**Reference the product breakdown on back for availability.*

STEP 3: GRADE AND TEXTILE

GRADES & SWATCHES



[CLICK TO VIEW »](#)

FABRIC DIRECTION & COLOR GUIDE



[CLICK TO VIEW »](#)

COLOR GUIDE

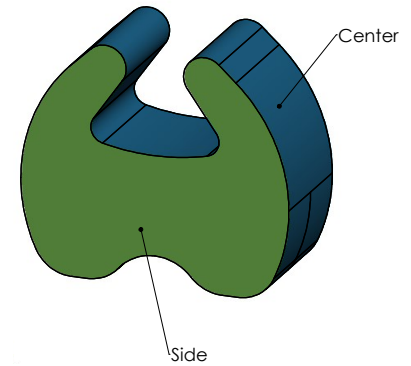

**Thread will default to match the seat textile.*

STEP 4: MODIFICATIONS (OPTIONAL)

EMBROIDERY

- Personalize your furniture with embroidery!
- We can embroider up to 12" x 15" artwork

EMBROIDERY SPECS

[CLICK TO VIEW »](#)



FLAME RETARDANT

- CAL TB-133
- Optional flame retardant add on.

**Reference the product breakdown on back for availability.*

BASE

- Non-skid base

STEP 5: CONFIGURE PART NUMBER

FILL IN YOUR PART NUMBER

F	K	0	3	4	-		x		x					-	Z			
FAMILY						STEP 1							STEP 2					
L						W			H				ZIP					

EXAMPLE PART NUMBER

F	K	0	3	4	-	3	0	x	1	5	x	2	8	.5	-	Z								
FAMILY						L							W				H				ZIP			

STEP 6: CONFIGURE DESCRIPTION

FILL IN YOUR DESCRIPTION

1. BANDING

1. Banding					
LOCATION	GRADE	MANUFACTURER	PATTERN	COLOR	

2. SIDE

2. Side					
LOCATION	GRADE	MANUFACTURER	PATTERN	COLOR	

EMBROIDERY*

LOCATION	NAME
----------	------

FLAME RETARDANT*

--

BASE*

--

STEP 3

EXAMPLE DESCRIPTION

1. BANDING

1. Banding	1	Spradling	Silvertex	Sage
LOCATION	GRADE	MANUFACTURER	PATTERN	COLOR

2. SIDE

2. Side	3	Momentum	Tribeca	Fossil
LOCATION	GRADE	MANUFACTURER	PATTERN	COLOR

EMBROIDERY*

Side	Rocket Logo
LOCATION	NAME

FLAME RETARDANT*

CAL TB-133

BASE*

Non-skid base

*Optional add-ons. Reference product breakdown for availability.

INCLUDE ON PURCHASE ORDER

EXAMPLE CONFIGURATION

FK034-30x15x28.5-Z

1. Banding: Grade 1, Spradling, Silvertex, Sage | 2. Side: Grade 3, Momentum, Tribeca, Fossil

Embroidery: Side, Rocket logo | CAL TB-133 | Non-skid base

PRODUCT BREAKDOWN

HUG CHAIR 2.0 (FK034)

Product No.	Dimen./Weight (L x W x H)	FOOT OPTIONS												INTEGRATED POWER OPTIONS						HPL	Emb.			
		Zip Z	Standard G1 L1		3" Premium R3 C3		6" Premium S16 S29 C6 T6 R6 M6				Standard G1 L1		3" Premium R3 C3		6" Premium S16 S29 C6 T6 R6 M6									
Junior FK034-30x15x28.5	30" x 15" x 28.5" 8 lbs. (15" Seat Height)	✓	-	-	-	-	-	-	-	-	-	-	-	-	-	-	-	-	-	-	-	-	-	✓
XL FK034-35x15x30.5	35" x 15" x 30.5" 11 lbs. (17" Seat Height)	✓	-	-	-	-	-	-	-	-	-	-	-	-	-	-	-	-	-	-	-	-	-	✓



ADDITIONAL RESOURCES



[CLICK TO VIEW »](#)