

# LOTUS SERIES ROCK'N ROLLER

Product No. F165

With its smooth-running design, the Rock'n Roller is both comfortable and ready for active learning. The curve in the base encourages healthy movement with a safe and smooth rocking motion. Solid foam construction offers a lightweight seating solution perfect for the individual learner or easily adapt your space to accommodate a collaborative group session.



## DETAILS

### CONSTRUCTION

- Solid foam construction
- Reinforced seams and stitching
- Fully zippered (no wood base)
- Made in USA
- Backed with a lifetime warranty
- No pinch points



### MODIFICATION

- Textile & placement
- *Non-skid base available*
- Colored stitching and zipper
- Embroidery



## HOW TO SPECIFY F165

### STEP 1: SEAT HEIGHT

DIMENSION (L x W x H)	SEAT HEIGHT	DIMENSION (L x W x H)	SEAT HEIGHT	DIMENSION (L x W x H)	SEAT HEIGHT
	12"		16"		18"
16.5" x 21" x 21.54"		22" x 28" x 29"		24.5" x 31.5" x 32"	

### STEP 2: FULLY ZIPPERED

#### FULLY ZIPPERED



Fully Zippered (Z)

*\*Reference the product breakdown on back for availability.*

### STEP 3: GRADE AND TEXTILE

#### GRADES & SWATCHES



[CLICK TO VIEW »](#)

#### FABRIC DIRECTON & COLOR GUIDE



[CLICK TO VIEW »](#)

#### COLOR GUIDE

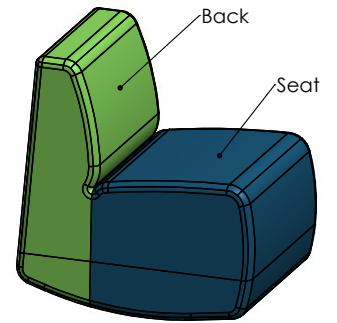

*\*Thread will default to match the seat textile.*

### STEP 4: MODIFICATIONS (OPTIONAL)

#### EMBROIDERY

- Personalize your furniture with embroidery!
- We can embroider up to 12" x 15" artwork

#### EMBROIDERY SPECS

[CLICK TO VIEW »](#)



#### FLAME RETARDANT

- CAL TB-133
- Optional flame retardant add on.

*\*Reference the product breakdown on back for availability.*

#### BASE

- Non-skid base

## STEP 5: CONFIGURE PART NUMBER

### FILL IN YOUR PART NUMBER

F	1	6	5	-		x		x							-	Z				
FAMILY					STEP 1								STEP 2							
					L				W				H				ZIP			

### EXAMPLE PART NUMBER

F	1	6	5	-	2	2	x	2	8	x	2	9			-	Z				
FAMILY					L				W				H				ZIP			

## STEP 6: CONFIGURE DESCRIPTION

### FILL IN YOUR DESCRIPTION

#### 1. SEAT

1. Seat					
LOCATION	GRADE	MANUFACTURER	PATTERN	COLOR	

#### 2. BACK

2. Back					
LOCATION	GRADE	MANUFACTURER	PATTERN	COLOR	

#### EMBROIDERY\*

LOCATION	NAME
----------	------

#### FLAME RETARDANT\*

--

#### BASE\*

--

STEP 3

### EXAMPLE DESCRIPTION

#### 1. SEAT

1. Seat	1	Spradling	Silvertex	Sage
LOCATION	GRADE	MANUFACTURER	PATTERN	COLOR

#### 2. BACK

2. Back	3	Momentum	Tribeca	Fossil
LOCATION	GRADE	MANUFACTURER	PATTERN	COLOR

#### EMBROIDERY\*

Seat	Rocket Logo
LOCATION	NAME

#### FLAME RETARDANT\*

CAL TB-133
------------

#### BASE\*

Non-skid base
---------------

\*Optional add-ons. Reference product breakdown for availability.

INCLUDE ON PURCHASE ORDER

## EXAMPLE CONFIGURATION

F165-22x28x29-Z

1. Seat: Grade 1, Spradling, Silvertex, Sage | 2. Back: Grade 3, Momentum, Tribeca, Fossil

Embroidery: Seat, Rocket logo | CAL TB-133 | Non-skid base

## PRODUCT BREAKDOWN

### ROCK'N ROLLER (F165)

Description/ Product No.	Dimen./Weight (L x W x H)	FOOT OPTIONS												INTEGRATED POWER OPTIONS								HPL	Emb.		
		Zip Z	Standard		3" Premium		6" Premium				Standard		3" Premium		6" Premium										
			G1	L1	R3	C3	S16	S29	C6	T6	R6	M6	G1	L1	R3	C3	S16	S29	C6	T6	R6	M6			
Small F165-16.5x21x21.54	16.5" x 21" x 21.54" 6.5 lbs. (12" Seat Height)	✓	-	-	-	-	-	-	-	-	-	-	-	-	-	-	-	-	-	-	-	-	-	-	✓
Medium F165-22x28x29	22" x 28" x 29" 15.5 lbs. (16" Seat Height)	✓	-	-	-	-	-	-	-	-	-	-	-	-	-	-	-	-	-	-	-	-	-	-	✓
Large F165-24.5x31.5x32	24.5" x 31.5" x 32" 22 lbs. (18" Seat Height)	✓	-	-	-	-	-	-	-	-	-	-	-	-	-	-	-	-	-	-	-	-	-	-	✓



1770 E. Keating Ave - Muskegon, MI 49442 • Tel: 231.366.4791 • [www.fomcore.com](http://www.fomcore.com)

#### ADDITIONAL RESOURCES



[CLICK TO VIEW »](#)