

CONNECT SERIES

# CONNECT LOW BACK TABLE

Product No. F138

Create. Collaborate. Connect. The simple and narrow size of the Connect Low Back Table can easily be placed with any of the other Connect Series products. By adding laminate and power the functionality of the piece is endless for any space.

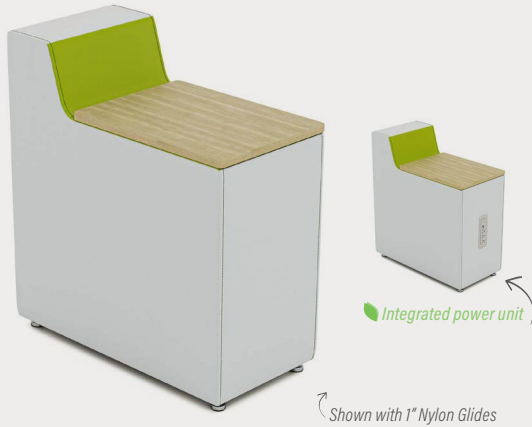

## DETAILS

### CONSTRUCTION

- Solid foam construction
- Wood base to fit foot options
- Reinforced seams and stitching
- Made in USA
- Backed with a lifetime warranty

### MODIFICATION

- Textile and placement
- Foot and finish options
- Stitching color
- Embroidery
- Power options
- HPL Worksurface

## QUICK COMBOS

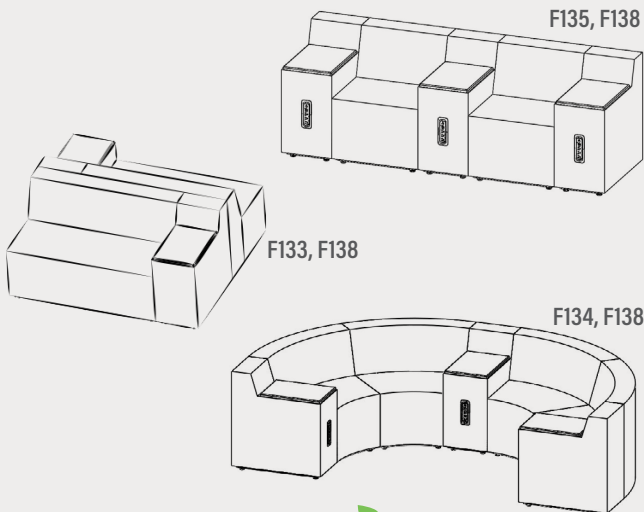

# HOW TO SPECIFY F138

## STEP 1: HEIGHT

### DIMENSION (L x W x H)

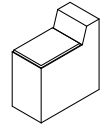

14" x 28" x 31"

## STEP 2: FOOT

### 1" STANDARD FOOT OPTIONS

- Nylon Glide (G1)
- Felt Glide (G1)
- 1" Low Profile Leg (L1) Black

### 3" PREMIUM FOOT OPTIONS

- 3" Rectangle (R3) Black
- 3" Rectangle (R3) Silver
- 3" Caster (C3)

### 6" PREMIUM FOOT OPTIONS

- 6" Mod Leg (M6)
- 6" Rectangle (R6) Black
- 6" Rectangle (R6) Silver
- 6" Triangle (T6) Black
- 6" Triangle (T6) Silver

\*Reference the product breakdown on back for availability.

## STEP 3: GRADE AND TEXTILE

### GRADES & SWATCHES



[CLICK TO VIEW >>](#)

### FABRIC DIRECTION & COLOR GUIDE



[CLICK TO VIEW >>](#)

\*Thread will default to match the seat textile.

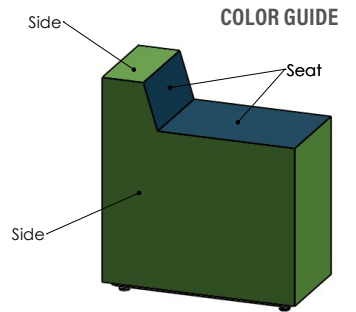

## STEP 4: MODIFICATIONS (OPTIONAL)

### HPL WORKSURFACE (HPL)

- Black Matte
- Black Gloss - Writable Surface

#### EDGE BANDING OPTIONS

- Black Matte/Gloss
- Spectrum Red
- Chrome Yellow
- Orange Grove
- Spectrum Blue

- Dover White Matte
- Dover White Gloss - Writable Surface

#### EDGE BANDING OPTIONS

- White Matte/Gloss
- Black Matte/Gloss
- Spectrum Red
- Chrome Yellow
- Orange Grove
- Spectrum Blue
- Navy Blue

- Gull Grey w/ matching edgebanding

- Chelsea Maple w/ matching edgebanding

- Black Riftwood w/ matching edgebanding

- White Twill w/ matching edgebanding

## STEP 4 (CONT.): MODIFICATIONS (OPTIONAL)

### EMBROIDERY

- Personalize your furniture with embroidery!
- We can embroider up to 12" x 15" artwork

### EMBROIDERY SPECS

[CLICK TO VIEW »](#)



### FLAME RETARDANT

- CAL TB-133
- Optional flame retardant add on.

### INTEGRATED POWER OPTIONS\* (PI, PI+)



White



Silver

PI = 1 Power Unit

PI+ = 2 Power Units

## STEP 5: CONFIGURE PART NUMBER

### FILL IN YOUR PART NUMBER

|        |   |   |   |   |   |   |   |   |   |   |   |        |   |  |  |                    |      |  |  |   |     |  |  |  |       |  |  |  |
|--------|---|---|---|---|---|---|---|---|---|---|---|--------|---|--|--|--------------------|------|--|--|---|-----|--|--|--|-------|--|--|--|
| F      | 1 | 3 | 8 | - | 1 | 4 | x | 2 | 8 | x | 3 | 1      | - |  |  |                    |      |  |  | - |     |  |  |  |       |  |  |  |
| FAMILY |   |   |   |   | L |   |   |   | W |   |   |        | H |  |  |                    | FOOT |  |  |   | HPL |  |  |  | POWER |  |  |  |
| STEP 1 |   |   |   |   |   |   |   |   |   |   |   | STEP 2 |   |  |  | STEP 4* (OPTIONAL) |      |  |  |   |     |  |  |  |       |  |  |  |

### EXAMPLE PART NUMBER

|        |   |   |   |   |   |   |   |   |   |   |   |   |   |   |   |   |      |   |   |   |     |  |  |  |       |  |  |  |
|--------|---|---|---|---|---|---|---|---|---|---|---|---|---|---|---|---|------|---|---|---|-----|--|--|--|-------|--|--|--|
| F      | 1 | 3 | 8 | - | 1 | 4 | x | 2 | 8 | x | 3 | 1 | - | R | 6 | - | H    | P | L | P | 1   |  |  |  |       |  |  |  |
| FAMILY |   |   |   |   | L |   |   |   | W |   |   |   | H |   |   |   | FOOT |   |   |   | HPL |  |  |  | POWER |  |  |  |

## STEP 6: CONFIGURE DESCRIPTION

### FILL IN YOUR DESCRIPTION

#### 1. SEAT

|          |       |              |         |       |
|----------|-------|--------------|---------|-------|
| 1. Seat  |       |              |         |       |
| LOCATION | GRADE | MANUFACTURER | PATTERN | COLOR |

#### 2. SIDE

|          |       |              |         |       |
|----------|-------|--------------|---------|-------|
| 2. Side  |       |              |         |       |
| LOCATION | GRADE | MANUFACTURER | PATTERN | COLOR |

#### FOOT

|            |
|------------|
|            |
| NAME/COLOR |

#### POWER\*

|       |          |
|-------|----------|
|       |          |
| COLOR | QUANTITY |

#### HPL WORKSURFACE\*

|           |                    |
|-----------|--------------------|
|           |                    |
| HPL COLOR | EDGE BANDING COLOR |

#### EMBROIDERY\*

|          |      |
|----------|------|
|          |      |
| LOCATION | NAME |

#### FIRE RETARDANCY\*

|  |
|--|
|  |
|--|

STEP 3

### EXAMPLE DESCRIPTION

#### 1. SEAT

|          |       |              |           |       |
|----------|-------|--------------|-----------|-------|
| 1. Seat  | 1     | Spradling    | Silvertex | Sage  |
| LOCATION | GRADE | MANUFACTURER | PATTERN   | COLOR |

#### 2. SIDE

|          |       |              |         |        |
|----------|-------|--------------|---------|--------|
| 2. Side  | 3     | Momentum     | Tribeca | Fossil |
| LOCATION | GRADE | MANUFACTURER | PATTERN | COLOR  |

#### FOOT

|                          |       |          |
|--------------------------|-------|----------|
| 6" Rectangle Leg - Black | White | 1        |
| NAME/COLOR               | COLOR | QUANTITY |

#### HPL WORKSURFACE\*

|             |                    |
|-------------|--------------------|
| Black Matte | Spectrum Red       |
| HPL COLOR   | EDGE BANDING COLOR |

#### EMBROIDERY\*

|          |             |
|----------|-------------|
| Seat     | Rocket Logo |
| LOCATION | NAME        |

#### FIRE RETARDANCY\*

|            |
|------------|
| CAL TB-133 |
|------------|

\*Optional add-ons. Reference product breakdown for availability.

INCLUDE ON PURCHASE ORDER

### EXAMPLE CONFIGURATION

F138-14x28x31-R6-HPLP1

1. Seat: Grade 1, Spradling, Silvertex, Sage | 2. Side: Grade 3, Momentum, Tribeca, Fossil

Foot: 6" Rectangle Leg Black | Power: White, Quantity: 1 | | HPL Worksurface: Black Matte, Edgebanding: Spectrum Red | Embroidery: Seat, Rocket logo | CAL TB-133

### PRODUCT BREAKDOWN

## CONNECT LOW BACK TABLE (F138)

| Product No.   | Dimen./Weight<br>(L x W x H) | FOOT OPTIONS |          |    |            |    |            |     |    |    |    |          | INTEGRATED POWER OPTION |            |    |            |     |     |    |    | HPL | Emb. |    |       |   |
|---------------|------------------------------|--------------|----------|----|------------|----|------------|-----|----|----|----|----------|-------------------------|------------|----|------------|-----|-----|----|----|-----|------|----|-------|---|
|               |                              | Zip<br>Z     | Standard |    | 3" Premium |    | 6" Premium |     |    |    |    | Standard |                         | 3" Premium |    | 6" Premium |     |     |    |    |     |      |    |       |   |
|               |                              |              | G1       | L1 | R3         | C3 | S16        | S29 | C6 | T6 | R6 | M6       | G1                      | L1         | R3 | C3         | S16 | S29 | C6 | T6 |     |      | R6 | M6    |   |
| F138-14x28x31 | 14" x 28" x 31"<br>19 lbs.   | -            | ✓        | ✓  | ✓          | ✓  | -          | -   | -  | ✓  | ✓  | ✓        | ✓                       | ✓          | ✓  | ✓          | ✓   | -   | -  | -  | ✓   | ✓    | ✓  | incl. | ✓ |

**Fomcore**  
SERVE. CREATE. INSPIRE.

1770 E. Keating Ave - Muskegon, MI 49442 • Tel: 231.366.4791 • [www.fomcore.com](http://www.fomcore.com)

### ADDITIONAL RESOURCES



[CLICK TO VIEW »](#)