

# CREATE YOUR COMBO BEEHIVE COMBO

Product No. F004

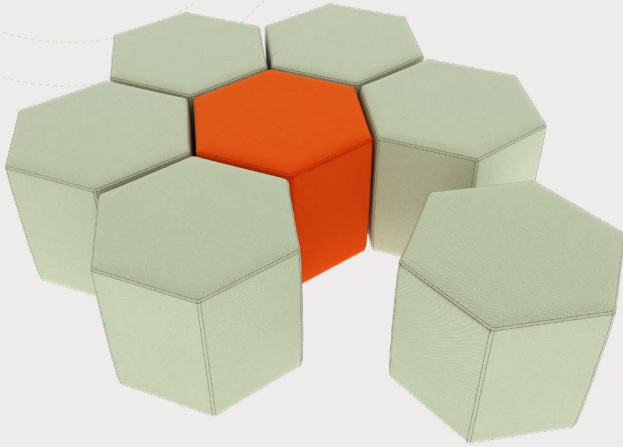

## DETAILS

### CONSTRUCTION

- Solid foam construction
- Wood base to fit foot options
- Reinforced seams and stitching
- Made in USA
- Backed with a lifetime warranty

### MODIFICATION

- Seat height
- Textile and placement
- Foot and finish options
- Fully zippered (no wood base)
- Stitching and zipper colors
- HPL work surface
- Embroidery

**WEATHER RESISTANT**  
See series page for more details. »



## COMBO BREAKDOWN

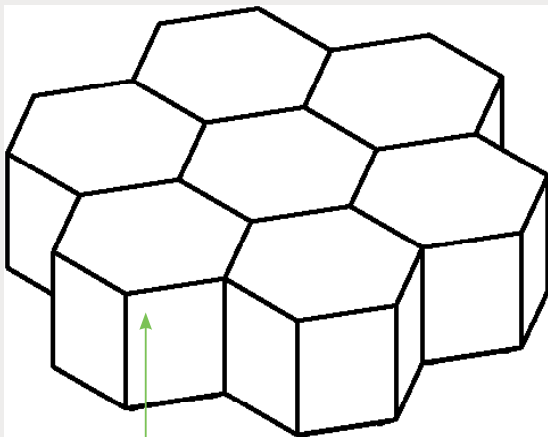

(7) Honeycomb Ottomans

**Fōmcore**  
SERVE. CREATE. INSPIRE.

# HOW TO SPECIFY A BEEHIVE COMBO

## STEP 1: SEAT HEIGHT

### HONEYCOMB

DIMENSION (L x W)	SEAT HEIGHT
	12"
	14"
	16"
	18"
	20"

## STEP 2: FOOT AND FULLY ZIPPERED

### FULLY ZIPPERED



### 1" STANDARD FOOT OPTIONS



### 3" PREMIUM FOOT OPTIONS



### 6" PREMIUM FOOT OPTIONS



\*Reference the product breakdown on back for availability.

## STEP 3: GRADE AND TEXTILE

### GRADES & SWATCHES



CLICK TO VIEW »

### FABRIC DIRECTION & COLOR GUIDE



CLICK TO VIEW »

### COLOR GUIDE

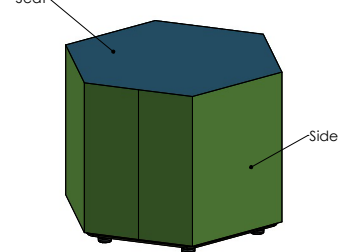

\*Thread will default to match the seat textile.

## STEP 4: MODIFICATIONS (OPTIONAL)

### HPL WORKSURFACE (HPL)

**Black Matte**  
**Black Gloss - Writable Surface**

EDGE-BANDING OPTIONS

Black Matte/Gloss Chrome Yellow Spectrum Blue  
Spectrum Red Orange Grove

**Gull Grey**  
w/ matching edging

**Chelsea Maple**  
w/ matching edging

**Dover White Matte**  
**Dover White Gloss - Writable Surface**

EDGE-BANDING OPTIONS

White Matte/Gloss Chrome Yellow Spectrum Blue  
Black Matte/Gloss Orange Grove Navy Blue  
Spectrum Red

**Black Riftwood**  
w/ matching edging

**White Twill**  
w/ matching edging

## STEP 4 (CONT.): MODIFICATIONS (OPTIONAL)

### EMBROIDERY

- Personalize your furniture with embroidery!
- We can embroider up to 12" x 15" artwork

\*Reference the product breakdown for availability.

### EMBROIDERY SPECS

[CLICK TO VIEW »](#)



### FLAME RETARDANT

- CAL TB-133
- Optional flame retardant add on.

## STEP 5: CONFIGURE PART NUMBER

### FILL IN YOUR PART NUMBER

F	0	0	4	-	x	x	x	x	-					-				
FAMILY					L					FOOT/ZIP				HPL				
					STEP 1					STEP 2				STEP 4* (OPTIONAL)				

### EXAMPLE PART NUMBER

F	0	0	4	-	2	4	x	2	1	x	1	2	-	G	1	-	H	P	L							
FAMILY					L					W					H				FOOT/ZIP				HPL			

## STEP 6: CONFIGURE DESCRIPTION

### FILL IN YOUR DESCRIPTION

#### 1. SEAT

1. Seat					
LOCATION	GRADE	MANUFACTURER	PATTERN	COLOR	

#### 2. SIDE

2. Side					
LOCATION	GRADE	MANUFACTURER	PATTERN	COLOR	

#### FOOT

NAME/COLOR	

#### HPL WORKSURFACE\*

HPL COLOR	EDGE-BANDING COLOR

#### EMBROIDERY\*

LOCATION	NAME

#### FLAME RETARDANT\*

--

STEP 3

### EXAMPLE DESCRIPTION

#### 1. SEAT

1. Seat	1	Spradling	Silvertex	Sage
LOCATION	GRADE	MANUFACTURER	PATTERN	COLOR

#### 2. SIDE

2. Side	3	Momentum	Tribeca	Fossil
LOCATION	GRADE	MANUFACTURER	PATTERN	COLOR

#### FOOT

1" Nylon Glide
NAME/COLOR

#### HPL WORKSURFACE\*

Black Matte	Spectrum Red
HPL COLOR	EDGE-BANDING COLOR

#### EMBROIDERY\*

Seat	Rocket Logo
LOCATION	NAME

#### FLAME RETARDANT\*

CAL TB-133
------------

\*Optional add-ons. Reference product breakdown for availability.

INCLUDE ON PURCHASE ORDER

REPEAT STEP 5 & 6 FOR EACH PRODUCT NUMBER.

### EXAMPLE CONFIGURATION

F004-24x21x12-G1-HPL

1. Seat: Grade 1, Spradling, Silvertex, Sage | 2. Side: Grade 3, Momentum, Tribeca, Fossil

Foot: 1" Nylon Glide | Power: White, Quantity: 1 | HPL Worksurface: Black Matte, Edgebanding: Spectrum Red | Embroidery: Seat, Rocket logo | CAL TB-133

## PRODUCT BREAKDOWN

### BEEHIVE COMBO

Description/ Product No.	Dimen./Weight (L x W x H)	FOOT OPTIONS												INTEGRATED POWER OPTION						HPL	Emb.		
		Zip Z	Standard		3" Premium		6" Premium				Standard		3" Premium		6" Premium								
			G1	L1	R3	C3	S16	S29	C6	T6	R6	M6	G1	L1	R3	C3	S16	S29	C6			T6	R6
Honeycomb Ottoman F004-24x21x12	24" x 21" x 12" 10 lbs.	✓	✓	✓	✓	✓	-	-	✓	✓	✓	✓	-	-	-	-	-	-	-	-	-	✓	✓
Honeycomb Ottoman F004-24x21x14	24" x 21" x 14" 11 lbs.	✓	✓	✓	✓	✓	-	-	✓	✓	✓	✓	-	-	-	-	-	-	-	-	-	✓	✓
Honeycomb Ottoman F004-24x21x16	24" x 21" x 16" 12 lbs.	✓	✓	✓	✓	✓	-	-	✓	✓	✓	✓	-	-	-	-	-	-	-	-	-	✓	✓
Honeycomb Ottoman F004-24x21x18	24" x 21" x 18" 13 lbs.	✓	✓	✓	✓	✓	-	-	✓	✓	✓	✓	-	-	-	-	-	-	-	-	-	✓	✓
Honeycomb Ottoman F004-24x21x20	24" x 21" x 20" 14 lbs.	✓	✓	✓	✓	✓	-	-	✓	✓	✓	✓	-	-	-	-	-	-	-	-	-	✓	✓



1770 E. Keating Ave - Muskegon, MI 49442 • Tel: 231.366.4791 • [www.fomcore.com](http://www.fomcore.com)

### ADDITIONAL RESOURCES



[CLICK TO VIEW »](#)