

SOCIAL SERIES

# LEFT SOCIAL CHAIR

Product No. F051

Create a welcoming environment for your next space. Featuring comfortable, functional, and creative seating options. The Left Social Chair is a keystone piece all on it's own or create an adaptable seating arrangement using multiple pieces from the Social series.



## DETAILS

### CONSTRUCTION

- Solid foam construction
- Wood base to fit foot options
- Reinforced seams and stitching
- Made in USA
- Backed with a lifetime warranty

### MODIFICATION

- Textile and placement
- Foot and finish options
- Stitching color
- Power options
- Embroidery

## QUICK COMBOS

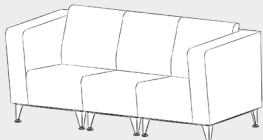

F052, F053, F051



F051

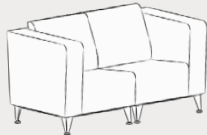

F052, F051

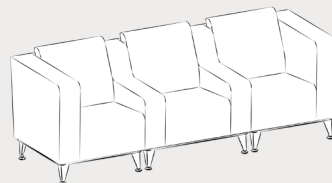

F052, F050, F051

# HOW TO SPECIFY F051

## STEP 1: SEAT HEIGHT

DIMENSION (L x W x H)	SEAT HEIGHT
 28.25" x 36" x 32"	18"

## STEP 2: FOOT AND FULLY ZIPPERED

### 6" PREMIUM FOOT OPTIONS



Large Sled Leg (S29)  
Silver



Large Sled Leg (S29)  
Black



6" Mod Leg (M6)



6" Caster (C6)



6" Rectangle (R6)  
Black



6" Rectangle (R6)  
Silver



6" Triangle (T6)  
Black



6" Triangle (T6)  
Silver

\*Reference the product breakdown on back for availability.

## STEP 3: GRADE AND TEXTILE

### GRADES & SWATCHES



[CLICK TO VIEW »](#)

### FABRIC DIRECTION & COLOR GUIDE



[CLICK TO VIEW »](#)

Pillow

COLOR GUIDE

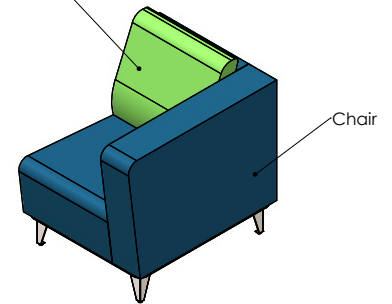

Chair

\*Thread will default to match the seat textile.

## STEP 4: MODIFICATIONS (OPTIONAL)

### INTEGRATED POWER OPTIONS\* (PI, PI+)



White



Silver

PI = 1 Power Unit

PI+ = 2 Power Units

### EMBROIDERY

- Personalize your furniture with embroidery!
- We can embroider up to 12" x 15" artwork

### EMBROIDERY SPECS

[CLICK TO VIEW »](#)



### FLAME RETARDANT

- CAL TB-133 - Optional flame retardant add on.

\*Reference the product breakdown on back for availability.

## STEP 5: CONFIGURE PART NUMBER

### FILL IN YOUR PART NUMBER

F	0	5	1	-	2	8	.	2	5	x	3	6	x	3	2	-					-				
FAMILY					L				W				H				FOOT				POWER				
STEP 1																STEP 2				STEP 4* (OPTIONAL)					

### EXAMPLE PART NUMBER

F	0	5	1	-	2	8	.	2	5	x	3	6	x	3	2	-	R	6	-	P	1
FAMILY					L				W				H				FOOT		POWER		

## STEP 6: CONFIGURE DESCRIPTION

### FILL IN YOUR DESCRIPTION

#### 1. CHAIR

1. Chair				
LOCATION	GRADE	MANUFACTURER	PATTERN	COLOR

#### 2. PILLOW

2. Pillow				
LOCATION	GRADE	MANUFACTURER	PATTERN	COLOR

#### FOOT

NAME/COLOR
------------

#### POWER\*

COLOR	QUANTITY
-------	----------

#### EMBROIDERY\*

LOCATION	NAME
----------	------

#### FLAME RETARDANT\*

--

STEP 3

### EXAMPLE DESCRIPTION

#### 1. CHAIR

1. Chair	1	Spradling	Silvertex	Sage
LOCATION	GRADE	MANUFACTURER	PATTERN	COLOR

#### 2. PILLOW

2. Pillow	3	Momentum	Tribeca	Fossil
LOCATION	GRADE	MANUFACTURER	PATTERN	COLOR

#### FOOT

6" Rectangle Leg - Black	White	1
NAME/COLOR	COLOR	QUANTITY

#### EMBROIDERY\*

Seat	Rocket Logo
LOCATION	NAME

#### FLAME RETARDANT\*

CAL TB-133
------------

\*Optional add-ons. Reference product breakdown for availability.

INCLUDE ON PURCHASE ORDER

### EXAMPLE CONFIGURATION

F051-28.25x36x32-R6-PI

1. Chair: Grade 1, Spradling, Silvertex, Sage | 2. Pillow: Grade 3, Momentum, Tribeca, Fossil

Foot: 6" Rectangle Leg Black | Power: White, Quantity: 1 | Embroidery: Seat, Rocket logo | CAL TB-133

### PRODUCT BREAKDOWN

## LEFT SOCIAL CHAIR (F051)

Product No.	Dimen./Weight (L x W x H)	FOOT OPTIONS												INTEGRATED POWER OPTION								HPL	Emb.
		Zip Z	Standard		3" Premium		6" Premium				Standard		3" Premium		6" Premium								
			G1	L1	R3	C3	S16	S29	C6	T6	R6	M6	G1	L1	R3	C3	S16	S29	C6	T6	R6		
F051-28.25x36x32	28.25" x 36" x 32" 35 lbs. (18" Seat Height)	-	-	-	-	-	✓	✓	✓	✓	✓	-	-	-	-	-	✓	✓	✓	✓	✓	-	✓



1770 E. Keating Ave - Muskegon, MI 49442 • Tel: 231.366.4791 • [www.fomcore.com](http://www.fomcore.com)

### ADDITIONAL RESOURCES



[CLICK TO VIEW »](#)