

## STEP SERIES | BUBBLE STEPS

# BUBBLE CHAIR

Product No. F157

The Bubble Chair stands out with its distinctive, rounded design, offering both comfort and a unique style that transforms any space. Like the rest of our Bubble series, it's crafted from solid foam, making it a lightweight and durable seating option that's easy to move and reposition. Its curved silhouette and ergonomic support provide a comfortable seat for learners of all ages. Whether featured as a standalone statement piece or incorporated into a larger seating area, the Bubble Chair brings a stylish yet functional touch to lobbies, classrooms, and collaborative spaces.



Shown with 1" Nylon Glides

## DETAILS

### CONSTRUCTION

- Solid foam construction
- Wood base to fit foot options
- Reinforced seams and stitching
- Made in USA
- Backed with a lifetime warranty

### MODIFICATION

- Textile and placement
- Foot and Finish options
- Stitching color
- Embroidery

## QUICK COMBOS

IDEA STARTERS COMING SOON

# HOW TO SPECIFY F157

## STEP 1: HEIGHT

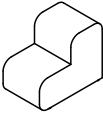
DIMENSION (L x W)	HEIGHT	STEP HEIGHT
 22" x 38"	32"	18"

## STEP 2: FOOT

### 1" STANDARD FOOT OPTIONS

-  Nylon Glide (G1)
-  Felt Glide (G1)
-  1" Low Profile Leg (L1)  
Black

\*Reference the product breakdown on back for availability.

## STEP 3: GRADE AND TEXTILE

### GRADES & SWATCHES



[CLICK TO VIEW »](#)

### FABRIC DIRECTON & COLOR GUIDE



[CLICK TO VIEW »](#)

### COLOR GUIDE

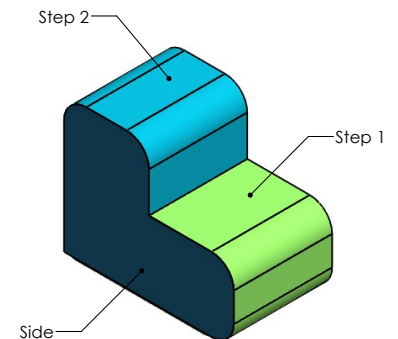

\*Thread will default to match the seat textile.

## STEP 4: MODIFICATIONS (OPTIONAL)

### EMBROIDERY

- Personalize your furniture with embroidery!
- We can embroider up to 12" x 15" artwork

### FLAME RETARDANT

- CAL TB-133
- Optional flame retardant add on.

### EMBROIDERY SPECS

[CLICK TO VIEW »](#)



\*Reference the product breakdown on back for availability.

## STEP 5: CONFIGURE PART NUMBER

### FILL IN YOUR PART NUMBER

F	1	5	7	-	2	2	x	3	8	x	3	2	-						
FAMILY					L				W				H				FOOT		
STEP 1												STEP 2							

### EXAMPLE PART NUMBER

F	1	5	7	-	2	2	x	3	8	x	3	2	-	G	1				
FAMILY					L				W				H				FOOT		

## STEP 6: CONFIGURE DESCRIPTION

### FILL IN YOUR DESCRIPTION

#### 1. SIDE

1. Side					
LOCATION	GRADE	MANUFACTURER	PATTERN	COLOR	

#### 2. STEP 1

2. Step 1					
LOCATION	GRADE	MANUFACTURER	PATTERN	COLOR	

#### 3. STEP 2

3. Step 2					
LOCATION	GRADE	MANUFACTURER	PATTERN	COLOR	

STEP 3

#### FOOT

1"-Nylon Glide
NAME/COLOR

#### EMBROIDERY\*

Seat	Rocket Logo
LOCATION	NAME

#### FIRE RETARDANCY\*

CAL TB-133
------------

### EXAMPLE DESCRIPTION

#### 1. SIDE

1. Side	1	Spradling	Silvertex	Sage
LOCATION	GRADE	MANUFACTURER	PATTERN	COLOR

#### 2. STEP - 1

2. Step 1	3	Momentum	Tribeca	Fossil
LOCATION	GRADE	MANUFACTURER	PATTERN	COLOR

#### 3. STEP - 2

3. Step 2	3	Momentum	Tribeca	Fossil
LOCATION	GRADE	MANUFACTURER	PATTERN	COLOR

#### FOOT

1"-Nylon Glide
NAME/COLOR

#### EMBROIDERY\*

Seat	Rocket Logo
LOCATION	NAME

#### FIRE RETARDANCY\*

CAL TB-133
------------

\*Optional add-ons. Reference product breakdown for availability.

INCLUDE ON PURCHASE ORDER

## EXAMPLE CONFIGURATION

F157-22x38x32-G1

1. Side: Grade 1, Spradling, Silvertex, Sage |

2. Step 1: Grade 3, Momentum, Tribeca, Fossil | 3. Step 2: Grade 3, Momentum, Tribeca, Fossil

Foot: 1" Nylon Glide | Embroidery: Seat, Rocket Logo | CAL TB-133

## PRODUCT BREAKDOWN

### BUBBLE CHAIR (F157)

Product No.	Dimen./Weight (L x W x H)	Zip Z	FOOT AND FINISH OPTIONS										INTEGRATED POWER OPTIONS										HPL	Emb.	
			Standard		3" Premium		6" Premium						Standard		3" Premium		6" Premium								
			G1	L1	R3	C3	S16	S29	C6	T6	R6	M6	G1	L1	R3	C3	S16	S29	C6	T6	R6	M6			
F157-22x38x32	22" x 38" x 32" 32 lbs.	-	✓	✓	-	-	-	-	-	-	-	-	-	-	-	-	-	-	-	-	-	-	-	-	✓

**Fōmcore**  
SERVE. CREATE. INSPIRE.

1770 E. Keating Ave - Muskegon, MI 49442 • Tel: 231.366.4791 • [www.fomcore.com](http://www.fomcore.com)

ADDITIONAL  
RESOURCES



CLICK TO VIEW »