

STEP SERIES | BUBBLE STEPS

BUBBLE TWO STEP INSIDE CORNER

Product No. F154

The Bubble Two Step Inside Corner brings a fresh twist to our classic Step Series. Featuring rounded edges, this piece blends eye-catching design with ergonomic support, making it a standout seat in any space. Our steps are crafted from solid foam, making them lightweight and easy to move. The absence of hard edges ensures safety for learners of all ages, while the versatile design allows for collaborative seating arrangements. Combine it with other pieces from the Bubble Step Series to create flexible seating solutions perfect for lobbies, common spaces, media centers, the spaces in between, and more.

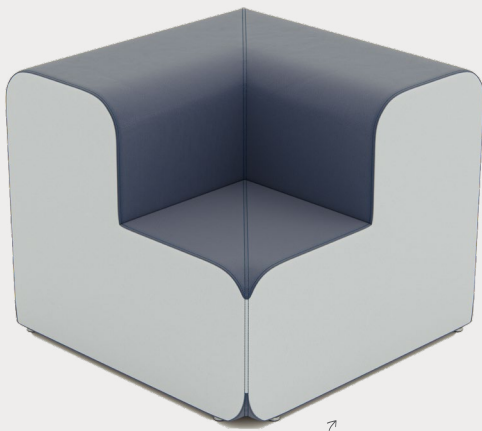

Shown with 1" Nylon Glides

DETAILS

CONSTRUCTION

- Solid foam construction
- Wood base to fit foot options
- Reinforced seams and stitching
- Made in USA
- Backed with a lifetime warranty

MODIFICATION

- Textile and placement
- Foot and Finish options
- Stitching color
- Embroidery

QUICK COMBOS

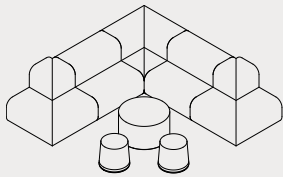

F005-22, F153, F154, F155, F166

MORE IDEA STARTERS COMING SOON

HOW TO SPECIFY F154

STEP 1: HEIGHT

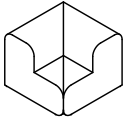
DIMENSION (L x W)	HEIGHT	STEP HEIGHT
 38" x 38"	32"	18"

STEP 2: FOOT

1" STANDARD FOOT OPTIONS

-  Nylon Glide (G1)
-  Felt Glide (G1)
-  1" Low Profile Leg (L1)
Black

*Reference the product breakdown on back for availability.

STEP 3: GRADE AND TEXTILE

GRADES & SWATCHES



[CLICK TO VIEW »](#)

FABRIC DIRECTON & COLOR GUIDE



[CLICK TO VIEW »](#)

COLOR GUIDE

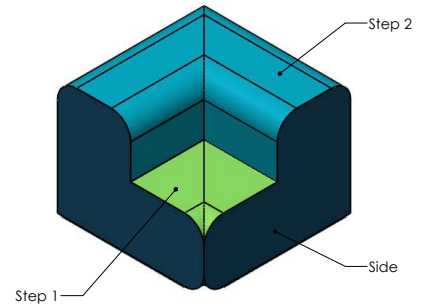

*Thread will default to match the seat textile.

STEP 4: MODIFICATIONS (OPTIONAL)

EMBROIDERY

- Personalize your furniture with embroidery!
- We can embroider up to 12" x 15" artwork

FLAME RETARDANT

- CAL TB-133
- Optional flame retardant add on.

EMBROIDERY SPECS

[CLICK TO VIEW »](#)



*Reference the product breakdown on back for availability.

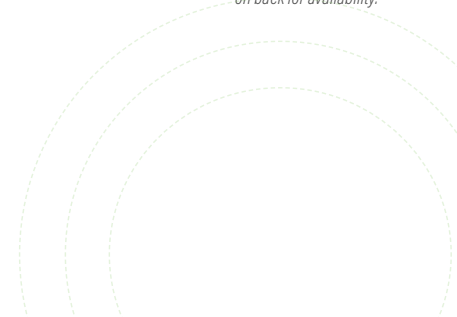

STEP 5: CONFIGURE PART NUMBER

FILL IN YOUR PART NUMBER

F	1	5	4	-	3	8	x	3	8	x	3	2	-			
FAMILY					STEP 1								FOOT			

EXAMPLE PART NUMBER

F	1	5	4	-	3	8	x	3	8	x	3	2	-	G	1	
FAMILY					STEP 1								FOOT			

STEP 6: CONFIGURE DESCRIPTION

FILL IN YOUR DESCRIPTION

1. SIDE

1. Side				
LOCATION	GRADE	MANUFACTURER	PATTERN	COLOR

2. STEP 1

2. Step 1				
LOCATION	GRADE	MANUFACTURER	PATTERN	COLOR

3. STEP 2

3. Step 2				
LOCATION	GRADE	MANUFACTURER	PATTERN	COLOR

STEP 3

FOOT

1"-Nylon Glide
NAME/COLOR

EMBROIDERY*

Seat	Rocket Logo
LOCATION	NAME

FIRE RETARDANCY*

CAL TB-133

EXAMPLE DESCRIPTION

1. SIDE

1. Side	1	Spradling	Silvertex	Sage
LOCATION	GRADE	MANUFACTURER	PATTERN	COLOR

2. STEP-1

2. Step 1	3	Momentum	Tribeca	Fossil
LOCATION	GRADE	MANUFACTURER	PATTERN	COLOR

3. STEP-2

3. Step 2	3	Momentum	Tribeca	Fossil
LOCATION	GRADE	MANUFACTURER	PATTERN	COLOR

FOOT

1"-Nylon Glide

NAME/COLOR

EMBROIDERY*

Seat	Rocket Logo
LOCATION	NAME

FIRE RETARDANCY*

CAL TB-133

*Optional add-ons. Reference product breakdown for availability.

INCLUDE ON PURCHASE ORDER

EXAMPLE CONFIGURATION

F154-38x38x32-G1

1. Side: Grade 1, Spradling, Silvertex, Sage |

2. Step 1: Grade 3, Momentum, Tribeca, Fossil | 3. Step 2: Grade 3, Momentum, Tribeca, Fossil

Foot: 1" Nylon Glide | Embroidery: Seat, Rocket logo | CAL TB-133

PRODUCT BREAKDOWN

BUBBLE TWO STEP INSIDE CORNER (F154)

Product No.	Dimen./Weight (L x W x H)	FOOT AND FINISH OPTIONS											INTEGRATED POWER OPTIONS								HPL	Emb.		
		Zip Z	Standard		3" Premium		6" Premium						Standard		3" Premium		6" Premium							
		G1	L1	R3	C3	S16	S29	C6	T6	R6	M6	G1	L1	R3	C3	S16	S29	C6	T6	R6	M6			
F154-38x38x32	38" x 38" x 32" 63 lbs.	-	✓	✓	-	-	-	-	-	-	-	-	-	-	-	-	-	-	-	-	-	-	-	✓

Fōmcore
SERVE. CREATE. INSPIRE.

1770 E. Keating Ave - Muskegon, MI 49442 • Tel: 231.366.4791 • www.fomcore.com

ADDITIONAL
RESOURCES



CLICK TO VIEW »