

STEP SERIES

# THREE STEP INSIDE CURVED CORNER

Product No. F089

The Three Step Curved Inside Corner is designed with a smoothly curved back, making it ideal for fluid, collaborative seating arrangements. Whether used alone or as part of a larger configuration, this piece offers versatile seating options that inspire creativity. The flat steps provide stable support, while the curved back adds a dynamic, modern touch. When combined with other pieces from our Step Series, this is the perfect addition to student-centered spaces like commons areas, media centers, the spaces in between, and more.

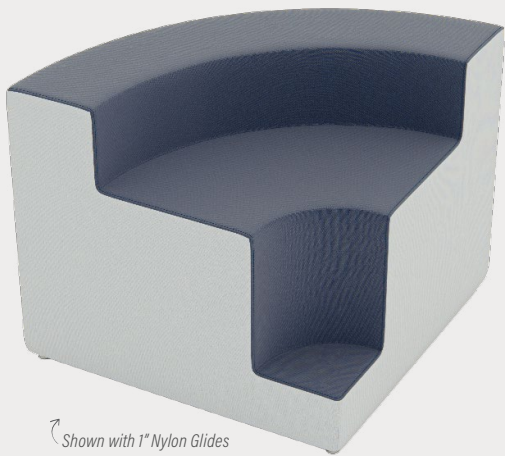

Shown with 1" Nylon Glides

## DETAILS

### CONSTRUCTION

- Solid foam construction
- Wood base to fit foot options
- Reinforced seams and stitching
- Made in USA
- Backed with a lifetime warranty

### MODIFICATION

- Textile and placement
- Foot and Finish options
- Stitching color
- Embroidery

## QUICK COMBOS

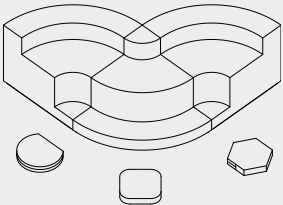

F089, F090, FK035, FK037, FK038

IDEA STARTERS COMING SOON



# HOW TO SPECIFY F089

## STEP 1: HEIGHT

DIMENSION (L x W)	HEIGHT	STEP 1 HEIGHT	STEP 2 HEIGHT
38" x 38"	32"	7"	16"

## STEP 2: FOOT

### 1" STANDARD FOOT OPTIONS

- Nylon Glide (G1)
- Felt Glide (G1)
- 1" Low Profile Leg (L1)  
Black

\*Reference the product breakdown on back for availability.

## STEP 3: GRADE AND TEXTILE

### GRADES & SWATCHES



[CLICK TO VIEW »](#)

### FABRIC DIRECTON & COLOR GUIDE



[CLICK TO VIEW »](#)

### COLOR GUIDE

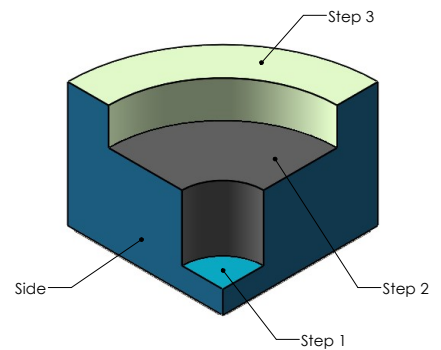

\*Thread will default to match the seat textile.

## STEP 4: MODIFICATIONS (OPTIONAL)

### EMBROIDERY

- Personalize your furniture with embroidery!
- We can embroider up to 12" x 15" artwork

### FLAME RETARDANT

- CAL TB-133
- Optional flame retardant add on.

### EMBROIDERY SPECS

[CLICK TO VIEW »](#)



\*Reference the product breakdown on back for availability.

## STEP 5: CONFIGURE PART NUMBER

### FILL IN YOUR PART NUMBER

F	0	8	9	-	3	8	x	3	8	x	3	2	-			
FAMILY					STEP 1								STEP 2			
L					W				H				FOOT			

### EXAMPLE PART NUMBER

F	0	8	9	-	3	8	x	3	8	x	3	2	-	G	1
FAMILY					STEP 1								STEP 2		
L					W				H				FOOT		

## STEP 6: CONFIGURE DESCRIPTION

### FILL IN YOUR DESCRIPTION

<b>1. SIDES</b>					STEP 3
1. Sides					
LOCATION	GRADE	MANUFACTURER	PATTERN	COLOR	
<b>2. BACK</b>					
2. Back					
LOCATION	GRADE	MANUFACTURER	PATTERN	COLOR	
<b>3. STEP 1</b>					
3. Step 1					
LOCATION	GRADE	MANUFACTURER	PATTERN	COLOR	
<b>4. STEP 2</b>					
4. Step 2					
LOCATION	GRADE	MANUFACTURER	PATTERN	COLOR	
<b>5. STEP 3</b>					
5. Step 3					
LOCATION	GRADE	MANUFACTURER	PATTERN	COLOR	
<b>FOOT</b>					
NAME/COLOR					
<b>EMBROIDERY*</b>					
LOCATION		NAME			
<b>FIRE RETARDANCY*</b>					
CAL TB-133					

### EXAMPLE DESCRIPTION

<b>1. SIDES</b>				
1. Sides	1	Spradling	Silvertex	Sage
LOCATION	GRADE	MANUFACTURER	PATTERN	COLOR
<b>2. BACK</b>				
2. Back	3	Momentum	Tribeca	Fossil
LOCATION	GRADE	MANUFACTURER	PATTERN	COLOR
<b>3. STEP - 1</b>				
3. Step 1	3	Momentum	Tribeca	Fossil
LOCATION	GRADE	MANUFACTURER	PATTERN	COLOR
<b>4. STEP - 2</b>				
4. Step 2	3	Momentum	Tribeca	Fossil
LOCATION	GRADE	MANUFACTURER	PATTERN	COLOR
<b>5. STEP - 3</b>				
5. Step 3	3	Momentum	Tribeca	Fossil
LOCATION	GRADE	MANUFACTURER	PATTERN	COLOR
<b>FOOT</b>				
1" Nylon Glide				
NAME/COLOR				
<b>EMBROIDERY*</b>				
Seat		Rocket Logo		
LOCATION	NAME			
<b>FIRE RETARDANCY*</b>				
CAL TB-133				

\*Optional add-ons. Reference product breakdown for availability.

INCLUDE ON PURCHASE ORDER

## EXAMPLE CONFIGURATION

F089-38x38x32-G1

1. Sides: Grade 1, Spradling, Silvertex, Sage | 2. Back: Grade 3, Momentum, Tribeca, Fossil | 3. Step -1: Grade 3, Momentum, Tribeca, Fossil |  
 4. Step-2: Grade 3, Momentum, Tribeca, Fossil | 5. Step-3: Grade 3, Momentum, Tribeca, Fossil  
 Foot: 1" Nylon Glide | Embroidery: Seat, Rocket logo | CAL TB-133

## PRODUCT BREAKDOWN

### THREE STEP INSIDE CURVED CORNER

Product No.	Dimen./Weight (L x W x H)	Zip Z	FOOT AND FINISH OPTIONS										INTEGRATED POWER OPTIONS								HPL	Emb.	
			Standard G1	LI	3" Premium R3 C3		6" Premium S16 S29 C6 T6 R6 M6				Standard G1 LI		3" Premium R3 C3 S16 S29 C6 T6 R6 M6										
F089-38x38x32	38" x 38" x 32" 48 lbs.	-	✓	✓	-	-	-	-	-	-	-	-	-	-	-	-	-	-	-	-	-	-	✓



1770 E. Keating Ave - Muskegon, MI 49442 • Tel: 231.366.4791 • [www.fomcore.com](http://www.fomcore.com)

ADDITIONAL RESOURCES



CLICK TO VIEW »