

# OTTOMAN & BENCH SERIES BOWTIE BENCH

Product No. F077

Our Bowtie Bench is a unique shape that can bring added style to the space. You can use 5 Bowtie Benches and an ottoman to make a Bowtie Combo to make a collaboration space.



Shown with 1" Nylon Glides

## DETAILS

### CONSTRUCTION

- Solid foam construction
- Wood base to fit foot options
- Reinforced seams and stitching
- Made in USA
- Backed with a lifetime warranty

### MODIFICATION

- Seat height
- Textile and placement
- Foot and finish options
- Fully zippered (no wood base)
- Stitching and zipper colors
- Embroidery

## QUICK COMBOS

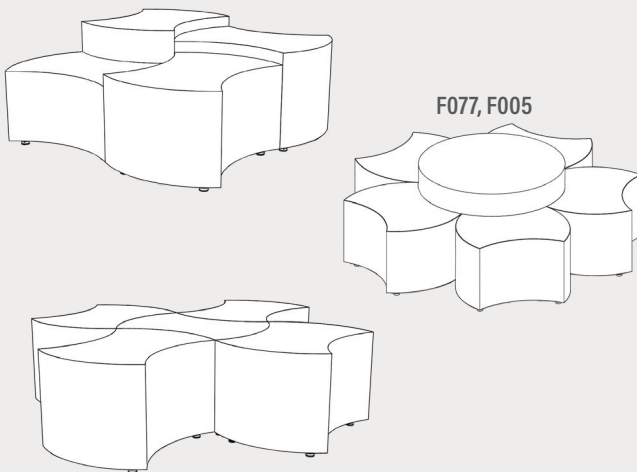

F077, F005

**Fōmcore**  
SERVE. CREATE. INSPIRE.

# HOW TO SPECIFY F077

## STEP 1: SEAT HEIGHT

DIMENSION (L x W)	SEAT HEIGHT
 28" x 21"	14"
	16"
	18"
	20"

## STEP 2: FOOT AND FULLY ZIPPERED

### FULLY ZIPPERED



### 1" STANDARD FOOT OPTIONS



### 3" PREMIUM FOOT OPTIONS



### 6" PREMIUM FOOT OPTIONS

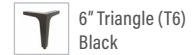

\*Reference the product breakdown on back for availability.

## STEP 3: GRADE AND TEXTILE

### GRADES & SWATCHES



[CLICK TO VIEW »](#)

### FABRIC DIRECTION & COLOR GUIDE



[CLICK TO VIEW »](#)

\*Thread will default to match the seat textile.

### COLOR GUIDE

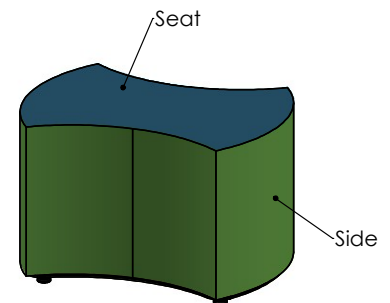

## STEP 4: MODIFICATIONS (OPTIONAL)

### EMBROIDERY

- Personalize your furniture with embroidery!
- We can embroider up to 12" x 15" artwork

### EMBROIDERY SPECS

[CLICK TO VIEW »](#)



### FLAME RETARDANT

- CAL TB-133
- Optional flame retardant add on.

\*Reference the product breakdown on back for availability.

## STEP 5: CONFIGURE PART NUMBER

### FILL IN YOUR PART NUMBER

F	0	7	7	-	x	x	x	x	-						
FAMILY					STEP 1				STEP 2						
L				W				H				FOOT/ZIP			

### EXAMPLE PART NUMBER

F	0	7	7	-	2	8	x	2	1	x	1	4	-	R	6					
FAMILY					L				W				H				FOOT/ZIP			

## STEP 6: CONFIGURE DESCRIPTION

### FILL IN YOUR DESCRIPTION

#### 1. SEAT

1. Seat					
LOCATION	GRADE	MANUFACTURER	PATTERN	COLOR	

#### 2. SIDE

2. Side					
LOCATION	GRADE	MANUFACTURER	PATTERN	COLOR	

#### FOOT

NAME/COLOR
------------

#### FIRE RETARDANCY\*

--

#### EMBROIDERY\*

LOCATION	NAME
----------	------

STEP 3

### EXAMPLE DESCRIPTION

#### 1. SEAT

1. Seat	1	Spradling	Silvertex	Sage
LOCATION	GRADE	MANUFACTURER	PATTERN	COLOR

#### 2. SIDE

2. Side	3	Momentum	Tribeca	Fossil
LOCATION	GRADE	MANUFACTURER	PATTERN	COLOR

#### FOOT

6" Rectangle Leg - Black
--------------------------

#### FIRE RETARDANCY\*

CAL TB-133
------------

#### NAME/COLOR

Seat	Rocket Logo
LOCATION	NAME

\*Optional add-ons. Reference product breakdown for availability.

INCLUDE ON PURCHASE ORDER

## EXAMPLE CONFIGURATION

F077-28x21x14-R6

1. Seat: Grade 1, Spradling, Silvertex, Sage | 2. Side: Grade 3, Momentum, Tribeca, Fossil

Foot: 6" Rectangle Leg Black | Embroidery: Seat, Rocket logo | CAL TB-133

## PRODUCT BREAKDOWN

### BOWTIE BENCH (F077)

5 Bowtie Benches used in a Bowtie Combo. See page 64 for combo details.

Product No.	Dimen./Weight (L x W x H)	FOOT AND FINISH OPTIONS												INTEGRATED POWER OPTIONS										HPL	Emb.
		Zip Z	Standard GI LI		3" Premium R3 C3		6" Premium S16 S29 C6 T6 R6 M6						Standard G1 L1		3" Premium R3 C3		6" Premium S16 S29 C6 T6 R6 M6								
F077-28x21x14	28" x 21" x 14" 12 lbs.	✓	✓	✓	✓	✓	-	-	-	✓	✓	✓	-	-	-	-	-	-	-	-	-	-	-	-	✓
F077-28x21x16	28" x 21" x 16" 13 lbs.	✓	✓	✓	✓	✓	-	-	-	✓	✓	✓	-	-	-	-	-	-	-	-	-	-	-	-	✓
F077-28x21x18	28" x 21" x 18" 14 lbs.	✓	✓	✓	✓	✓	-	-	-	✓	✓	✓	-	-	-	-	-	-	-	-	-	-	-	-	✓
F077-28x21x20	28" x 21" x 20" 15 lbs.	✓	✓	✓	✓	✓	-	-	-	✓	✓	✓	-	-	-	-	-	-	-	-	-	-	-	-	✓



ADDITIONAL RESOURCES



CLICK TO VIEW »