

# OTTOMAN & BENCH SERIES SPIN WEDGE OTTOMAN

Product No. F055

Functional meets fun in this unusually shaped ottoman. Its sleek curved shape makes for a fresh fun look. If you want to make it more unique, you can always use additional ottoman pieces to combine them and create your own style.



Shown with 1" Nylon Glides

## DETAILS

### CONSTRUCTION

- Solid foam construction
- Wood base to fit foot options
- Reinforced seams and stitching
- Made in USA
- Backed with a lifetime warranty

### MODIFICATION

- Seat height
- Textile and placement
- Foot and finish options
- Stitching and zipper colors
- Embroidery

**WEATHER RESISTANT**  
See series page for more details. »



## QUICK COMBOS

(5) F055

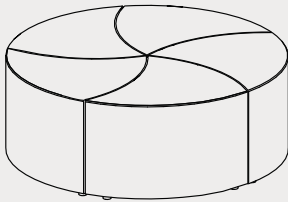

(6) F055

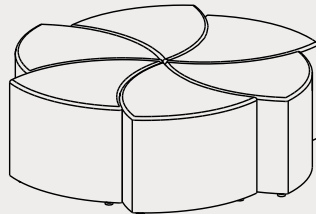

**Fōmcore**  
SERVE. CREATE. INSPIRE.

# HOW TO SPECIFY F055

## STEP 1: SEAT HEIGHT

DIMENSION (L x W)	HEIGHT
	12"
	14"
	16"
	18"

## STEP 2: FOOT

### 1" STANDARD FOOT OPTIONS



Nylon Glide (G1)



Felt Glide (G1)



1" Low Profile Leg (L1)  
Black

\*Reference the product breakdown on back for availability.

## STEP 3: GRADE AND TEXTILE

### GRADES & SWATCHES



CLICK TO VIEW »

### FABRIC DIRECTION & COLOR GUIDE



CLICK TO VIEW »

### COLOR GUIDE

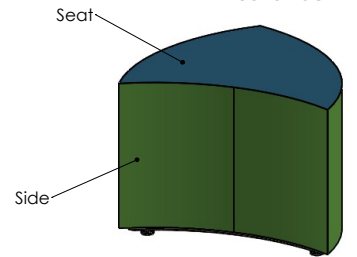

\*Thread will default to match the seat textile.

## STEP 4: MODIFICATIONS (OPTIONAL)

### EMBROIDERY

- Personalize your furniture with embroidery!
- We can embroider up to 12" x 15" artwork

### EMBROIDERY SPECS

CLICK TO VIEW »



### FLAME RETARDANT

- CAL TB-133
- Optional flame retardant add on.

\*Reference the product breakdown on back for availability.



## STEP 5: CONFIGURE PART NUMBER

### FILL IN YOUR PART NUMBER

F	0	5	5	-		x		x			-			
FAMILY					STEP 1						STEP 2			
L				W		H		FOOT						

### EXAMPLE PART NUMBER

F	0	5	5	-	2	4	x	2	3	x	1	2	-	L	1
FAMILY					L		W		H		FOOT				

## STEP 6: CONFIGURE DESCRIPTION

### FILL IN YOUR DESCRIPTION

#### 1. SEAT

1. Seat					
LOCATION	GRADE	MANUFACTURER	PATTERN	COLOR	

#### 2. SIDE

2. Side					
LOCATION	GRADE	MANUFACTURER	PATTERN	COLOR	

#### FOOT

NAME/COLOR
------------

#### EMBROIDERY\*

LOCATION	NAME
----------	------

#### FIRE RETARDANCY\*

--

STEP 3

### EXAMPLE DESCRIPTION

#### 1. SEAT

1. Seat	1	Spradling	Silvertex	Sage
LOCATION	GRADE	MANUFACTURER	PATTERN	COLOR

#### 2. SIDE

2. Side	3	Momentum	Tribeca	Fossil
LOCATION	GRADE	MANUFACTURER	PATTERN	COLOR

#### FOOT

6" Rectangle Leg - Black
NAME/COLOR

#### EMBROIDERY\*

Seat	Rocket Logo
LOCATION	NAME

#### FIRE RETARDANCY\*

CAL TB-133
------------

\*Optional add-ons. Reference product breakdown for availability.

INCLUDE ON PURCHASE ORDER

## EXAMPLE CONFIGURATION

F055-24x23x12-L1

1. Seat: Grade 1, Spradling, Silvertex, Sage | 2. Side: Grade 3, Momentum, Tribeca, Fossil

Foot: 1" Low Profile Leg Black | Embroidery: Seat, Rocket logo | CAL TB-133

## PRODUCT BREAKDOWN

### SPIN WEDGE OTTOMAN (F055)

Product No.	Dimen./Weight (L x W x H)	FOOT OPTIONS										INTEGRATED POWER OPTION						HPL	Emb.			
		Zip Z	Standard G1 L1		3" Premium R3 C3		6" Premium S16 S29 C6 T6 R6 M6				Standard G1 L1		3" Premium R3 C3		6" Premium S16 S29 C6 T6 R6 M6							
F055-24x23x12	24" x 23" x 12" 10 lbs.	-	✓	✓	-	-	-	-	-	-	-	-	-	-	-	-	-	-	-	-	-	✓
F055-24x23x14	24" x 23" x 14" 10 lbs.	-	✓	✓	-	-	-	-	-	-	-	-	-	-	-	-	-	-	-	-	-	✓
F055-24x23x16	24" x 23" x 16" 11 lbs.	-	✓	✓	-	-	-	-	-	-	-	-	-	-	-	-	-	-	-	-	-	✓
F055-24x23x18	24" x 23" x 18" 11 lbs.	-	✓	✓	-	-	-	-	-	-	-	-	-	-	-	-	-	-	-	-	-	✓

**Fōmcore**  
SERVE. CREATE. INSPIRE.

1770 E. Keating Ave - Muskegon, MI 49442 • Tel: 231.366.4791 • [www.fomcore.com](http://www.fomcore.com)

ADDITIONAL  
RESOURCES



CLICK TO VIEW »