

# NETWORK SERIES TRAPEZOID OTTOMAN 2.0

Product No. F047

With our light-weight, solid foam construction, you can maneuver the Trapezoid Ottoman 2.0 into endless combinations. Meetings, gatherings, and even quick chats will flourish in your purposefully curated spaces. Showcasing the variety of geometry from the Trapezoid Ottoman 2.0, your creativity has no bounds to craft the proper environment for any situation.



Shown with 1" Nylon Glides

## DETAILS

### CONSTRUCTION

- Solid foam construction
- Wood base to fit foot options
- Reinforced seams and stitching
- Made in USA
- Backed with a lifetime warranty

### MODIFICATION

- Textile and placement
- Foot and finish options
- Stitching color
- HPL Worksurface
- Embroidery
- Power options

## QUICK COMBOS

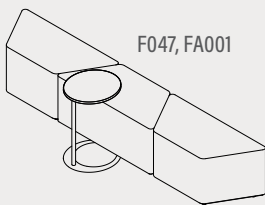

IDEA STARTERS COMING SOON

# HOW TO SPECIFY F047

## STEP 1: SEAT HEIGHT

DIMENSION (L x W)	SEAT HEIGHT
	16"
	18"

## STEP 2: FOOT

### FULLY ZIPPERED



### 1" STANDARD FOOT OPTIONS



### 3" PREMIUM FOOT OPTIONS



### 6" PREMIUM FOOT OPTIONS

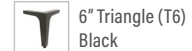
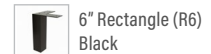

\*Reference the product breakdown on back for availability.

## STEP 3: GRADE AND TEXTILE

### GRADES & SWATCHES



CLICK TO VIEW »

### FABRIC DIRECTION & COLOR GUIDE



CLICK TO VIEW »

### COLOR GUIDE

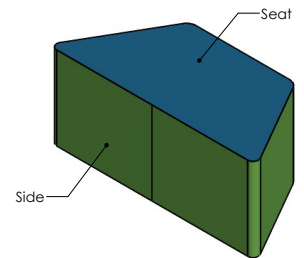

\*Thread will default to match the seat textile.

## STEP 4: MODIFICATIONS (OPTIONAL)

### HPL WORKSURFACE (HPL)

**Black Matte**  
**Black Gloss - Writable Surface**

EDGE-BANDING OPTIONS

Black Matte/Gloss    Chrome Yellow    Spectrum Blue  
Spectrum Red    Orange Grove

**Gull Grey**  
w/ matching edgebanding

**Chelsea Maple**  
w/ matching edgebanding

**Dover White Matte**  
**Dover White Gloss - Writable Surface**

EDGE-BANDING OPTIONS

White Matte/Gloss    Chrome Yellow    Spectrum Blue  
Black Matte/Gloss    Orange Grove    Navy Blue  
Spectrum Red

**Black Riftwood**  
w/ matching edgebanding

**White Twill**  
w/ matching edgebanding

## STEP 4 (CONT.): MODIFICATIONS (OPTIONAL)

### EMBROIDERY

- Personalize your furniture with embroidery!
- We can embroider up to 12" x 15" artwork

### EMBROIDERY SPECS

[CLICK TO VIEW »](#)



### FLAME RETARDANT

- CAL TB-133
- Optional flame retardant add on.

### INTEGRATED POWER OPTIONS\* (PI, PI+)



White



Silver

PI = 1 Power Unit  
PI+ = 2 Power Units

## STEP 5: CONFIGURE PART NUMBER

### FILL IN YOUR PART NUMBER

F	0	4	7	-	x	x	x	x	-					-					-									
FAMILY					L				W				H				FOOT				HPL				POWER			
												STEP 1				STEP 2				STEP 4* (OPTIONAL)								

### EXAMPLE PART NUMBER

F	0	4	7	-	4	0	x	1	8	x	1	8	-	M	6	-	H	P	L	-	P	I						
FAMILY					L				W				H				FOOT				HPL				POWER			

## STEP 6: CONFIGURE DESCRIPTION

### FILL IN YOUR DESCRIPTION

#### 1. SEAT

1. Seat					
LOCATION	GRADE	MANUFACTURER	PATTERN	COLOR	

#### 2. SIDE

2. Side					
LOCATION	GRADE	MANUFACTURER	PATTERN	COLOR	

#### FOOT

NAME/COLOR

#### POWER\*

COLOR	QUANTITY

#### HPL WORKSURFACE\*

HPL COLOR	EDGE BANDING COLOR

#### EMBROIDERY\*

LOCATION	NAME

#### FIRE RETARDANCY\*

--

STEP 3

### EXAMPLE DESCRIPTION

#### 1. SEAT

1. Seat	1	Spradling	Silvertex	Sage
LOCATION	GRADE	MANUFACTURER	PATTERN	COLOR

#### 2. SIDE

2. Side	3	Momentum	Tribeca	Fossil
LOCATION	GRADE	MANUFACTURER	PATTERN	COLOR

#### FOOT

6" Mod Leg	White	1
NAME/COLOR	COLOR	QUANTITY

#### HPL WORKSURFACE\*

Black Matte	Spectrum Red
HPL COLOR	EDGE BANDING COLOR

#### EMBROIDERY\*

Seat	Rocket Logo
LOCATION	NAME

#### FIRE RETARDANCY\*

CAL TB-133

\*Optional add-ons. Reference product breakdown for availability.

INCLUDE ON PURCHASE ORDER

### EXAMPLE CONFIGURATION

F047-40x18x18-M6-HPL-PI

1. Seat: Grade 1, Spradling, Silvertex, Sage | 2. Side: Grade 3, Momentum, Tribeca, Fossil

Foot: 6" Mod Leg | Power: White, Quantity: 1 | HPL Worksurface: Black Matte, Edgebanding: Spectrum Red | Embroidery: Seat, Rocket logo | CAL TB-133

### PRODUCT BREAKDOWN

## TRAPEZOID OTTOMAN 2.0 (F047)

Product No.	Dimen./Weight (L x W x H)	FOOT AND FINISH OPTIONS												INTEGRATED POWER OPTIONS								HPL	Emb.	
		Zip Z	Standard G1 L1		3" Premium R3 C3		6" Premium S16 S29		C6 T6		R6 M6		Standard G1 L1		3" Premium R3 C3		6" Premium S16 S29		C6 T6		R6 M6			
F047-40x18x16	40" x 18" x 16" 15.5 lbs.	✓	✓	✓	-	✓	-	-	-	✓	✓	✓	✓	✓	-	✓	-	-	-	-	-	-	✓	✓
F047-40x18x18	40" x 18" x 18" 17 lbs.	✓	✓	✓	-	✓	-	-	-	✓	✓	✓	✓	✓	-	✓	-	-	-	-	-	✓	✓	✓

**Fōmcore**  
SERVE. CREATE. INSPIRE.

1770 E. Keating Ave - Muskegon, MI 49442 • Tel: 231.366.4791 • [www.fomcore.com](http://www.fomcore.com)

### ADDITIONAL RESOURCES



[CLICK TO VIEW »](#)