

STEP SERIES TWO STEP INSIDE CORNER

Product No. F029

This finely crafted foam step is built to impress. Since the Two Step Inside Corner is made of solid foam, it's light and convenient to move around and NO HARD EDGES, making it safe for learners of any age. With the entire STEP line you can fit them together for collaboration, tiered seating, or even small groups by simply shifting them around. The Step Series is a wonderful seating solution in transition spaces like, hallways and entry areas. Create a unique seating space in the center of a room or push them against a wall in any combination.

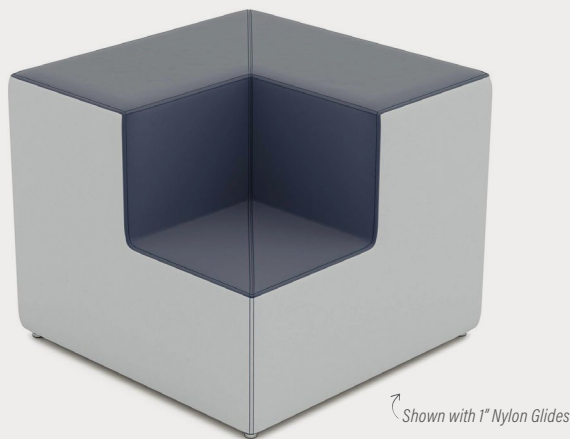

DETAILS

CONSTRUCTION

- Solid foam construction
- Wood base to fit foot options
- Reinforced seams and stitching
- Made in USA
- Backed with a lifetime warranty

MODIFICATION

- Textile and placement
- Foot and finish options
- Stitching color
- Power options
- Embroidery

QUICK COMBOS

F027, F030, F029

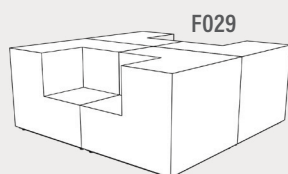
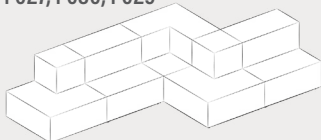

F027, F029

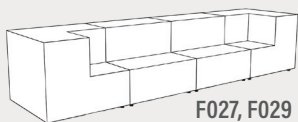
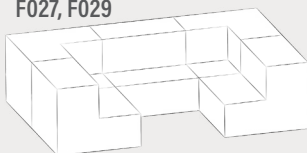

HOW TO SPECIFY F029

STEP 1: HEIGHT

DIMENSION (L x W)	HEIGHT	STEP HEIGHT
38" x 38"	32"	16.5"

STEP 2: FOOT

1" STANDARD FOOT OPTIONS

- Nylon Glide (G1)
- Felt Glide (G1)
- 1" Low Profile Leg (L1)
Black

**Reference the product breakdown on back for availability.*

STEP 3: GRADE AND TEXTILE

GRADES & SWATCHES



[CLICK TO VIEW »](#)

FABRIC DIRECTON & COLOR GUIDE



[CLICK TO VIEW »](#)

COLOR GUIDE

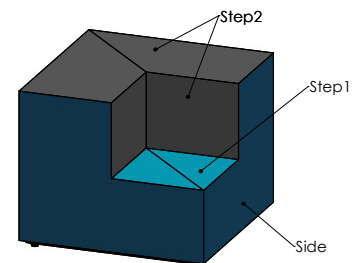

**Thread will default to match the seat textile.*

STEP 4: MODIFICATIONS (OPTIONAL)

INTEGRATED POWER OPTIONS* (PI, PI+)



White



Silver

PI = 1 Power Unit
PI+ = 2 Power Units

EMBROIDERY

- Personalize your furniture with embroidery!
- We can embroider up to 12" x 15" artwork

EMBROIDERY SPECS

[CLICK TO VIEW »](#)



FLAME RETARDANT

- CAL TB-133
- Optional flame retardant add on.

**Reference the product breakdown on back for availability.*

STEP 5: CONFIGURE PART NUMBER

FILL IN YOUR PART NUMBER

F	0	2	9	-	3	8	x	3	8	x	3	2	-				-			
FAMILY					STEP 1								STEP 2			STEP 4* (OPTIONAL)				
L					W				H				FOOT			POWER				

EXAMPLE PART NUMBER

F	0	2	9	-	3	8	x	3	8	x	3	2	-	G	1	-	P	1
FAMILY					STEP 1								STEP 2			STEP 4* (OPTIONAL)		
L					W				H				FOOT			POWER		

STEP 6: CONFIGURE DESCRIPTION

FILL IN YOUR DESCRIPTION

1. SIDE

1. Side				
LOCATION	GRADE	MANUFACTURER	PATTERN	COLOR

2. BACK

2. Back				
LOCATION	GRADE	MANUFACTURER	PATTERN	COLOR

3. STEP 1

3. Step 1				
LOCATION	GRADE	MANUFACTURER	PATTERN	COLOR

4. STEP 2

4. Step 2				
LOCATION	GRADE	MANUFACTURER	PATTERN	COLOR

FOOT

NAME/COLOR	

POWER*

COLOR		QUANTITY

EMBROIDERY*

LOCATION	NAME

FIRE RETARDANCY*

--

STEP 3

EXAMPLE DESCRIPTION

1. SIDE

1. Side	1	Spradling	Silvertex	Sage
LOCATION	GRADE	MANUFACTURER	PATTERN	COLOR

2. BACK

2. Back	3	Momentum	Tribeca	Fossil
LOCATION	GRADE	MANUFACTURER	PATTERN	COLOR

3. STEP-1

3. Step 1	3	Momentum	Tribeca	Fossil
LOCATION	GRADE	MANUFACTURER	PATTERN	COLOR

4. STEP-2

4. Step 2	3	Momentum	Tribeca	Fossil
LOCATION	GRADE	MANUFACTURER	PATTERN	COLOR

FOOT

1" Nylon Glide		POWER*
NAME/COLOR	White	1
	COLOR	QUANTITY

EMBROIDERY*

Seat	Rocket Logo
LOCATION	NAME

FIRE RETARDANCY*

CAL TB-133

*Optional add-ons. Reference product breakdown for availability.

INCLUDE ON PURCHASE ORDER

EXAMPLE CONFIGURATION

F029-38x38x32-G1-PI

1. Side: Grade 1, Spradling, Silvertex, Sage | 2. Back: Grade 3, Momentum, Tribeca, Fossil
 3. Step 1: Grade 3, Momentum, Tribeca, Fossil | 4. Step 2: Grade 3, Momentum, Tribeca, Fossil
 Foot: 1" Nylon Glide | Power: White, Quantity: 1 | Embroidery: Seat, Rocket logo | CAL TB-133

PRODUCT BREAKDOWN

TWO STEP INSIDE CORNER (F029)

Product No.	Dimen./Weight (L x W x H)	FOOT OPTIONS											INTEGRATED POWER OPTION						HPL	Emb.			
		Zip Z	Standard G1 L1		3" Premium R3 C3		6" Premium S16 S29 C6 T6 R6 M6						Standard G1 L1		3" Premium R3 C3 S16 S29 C6 T6 R6 M6								
F029-38x38x32	38" x 38" x 32" 58 lbs.	-	✓	✓	-	-	-	-	-	-	-	-	✓	✓	-	-	-	-	-	-	-	-	✓



ADDITIONAL RESOURCES



CLICK TO VIEW »