

STEP SERIES THREE STEP

Product No. F028

This finely crafted foam step is built to impress. Since the Three Step is made of solid foam, it's light and convenient to move around and NO HARD EDGES, making it safe for learners of any age. With the entire STEP line you can fit them together for collaboration, tiered seating, or even small groups by simply shifting them around. The Step Series is a wonderful seating solution in transition spaces like, hallways and entry areas. Create a unique seating space in the center of a room or push them against a wall in any combination.

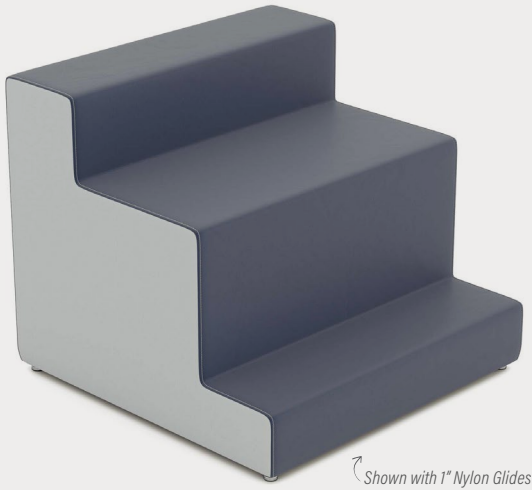

DETAILS

CONSTRUCTION

- Solid foam construction
- Reinforced seams and stitching
- Wood base to fit foot options
- Made in USA
- Backed with a lifetime warranty

MODIFICATION

- Textile and placement
- Foot and finish options
- Stitching color
- Power options
- Embroidery

QUICK COMBOS

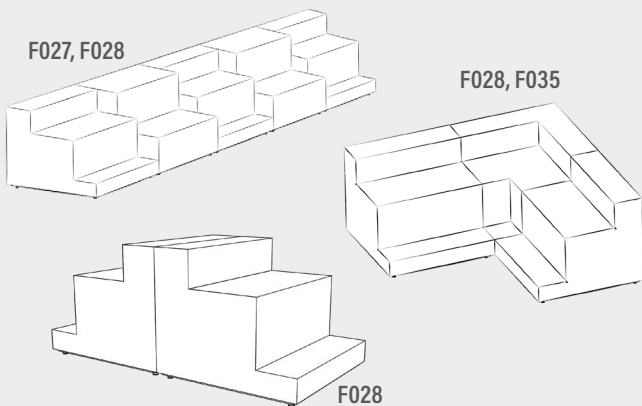

HOW TO SPECIFY F028

STEP 1: HEIGHT

DIMENSION (L x W)	HEIGHT	STEP 1 HEIGHT	STEP 2 HEIGHT
38" x 38"	32"	7"	23"

STEP 2: FOOT

1" STANDARD FOOT OPTIONS

- Nylon Glide (G1)
- Felt Glide (G1)
- 1" Low Profile Leg (L1)
Black

**Reference the product breakdown on back for availability.*

STEP 3: GRADE AND TEXTILE

GRADES & SWATCHES



[CLICK TO VIEW »](#)

FABRIC DIRECTON & COLOR GUIDE



[CLICK TO VIEW »](#)

COLOR GUIDE

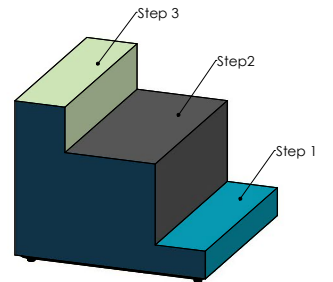

**Thread will default to match the seat textile.*

STEP 4: MODIFICATIONS (OPTIONAL)

INTEGRATED POWER OPTIONS* (PI, PI+)

- White
- Silver

PI = 1 Power Unit
PI+ = 2 Power Units

EMBROIDERY

- Personalize your furniture with embroidery!
- We can embroider up to 12" x 15" artwork

EMBROIDERY SPECS

[CLICK TO VIEW »](#)



FLAME RETARDANT

- CAL TB-133
- Optional flame retardant add on.

**Reference the product breakdown on back for availability.*

STEP 5: CONFIGURE PART NUMBER

FILL IN YOUR PART NUMBER

F	0	2	8	-	3	8	x	3	8	x	3	2	-				-					
FAMILY					L				W				H				FOOT			POWER		
STEP 1												STEP 2			STEP 4* (OPTIONAL)							

EXAMPLE PART NUMBER

F	0	2	8	-	3	8	x	3	8	x	3	2	-	G	1	-	P	I		
FAMILY					L				W				H				FOOT		POWER	

STEP 6: CONFIGURE DESCRIPTION

FILL IN YOUR DESCRIPTION

1. SIDE

1. Side				
LOCATION	GRADE	MANUFACTURER	PATTERN	COLOR

2. BACK

2. Back				
LOCATION	GRADE	MANUFACTURER	PATTERN	COLOR

3. STEP 1

3. Step 1				
LOCATION	GRADE	MANUFACTURER	PATTERN	COLOR

4. STEP 2

4. Step 2				
LOCATION	GRADE	MANUFACTURER	PATTERN	COLOR

5. STEP 3

5. Step 3				
LOCATION	GRADE	MANUFACTURER	PATTERN	COLOR

STEP 3

FOOT

1" Nylon Glide				
NAME/COLOR	COLOR	QUANTITY		

POWER*

White	1
COLOR	QUANTITY

EMBROIDERY*

Seat	Rocket Logo
LOCATION	NAME

FLAME RETARDANT*

CAL TB-133

EXAMPLE DESCRIPTION

1. SIDE

1. Side	1	Spradling	Silvertex	Sage
LOCATION	GRADE	MANUFACTURER	PATTERN	COLOR

2. BACK

2. Back	3	Momentum	Tribeca	Fossil
LOCATION	GRADE	MANUFACTURER	PATTERN	COLOR

3. STEP - 1

3. Step 1	3	Momentum	Tribeca	Fossil
LOCATION	GRADE	MANUFACTURER	PATTERN	COLOR

4. STEP - 2

4. Step 2	3	Momentum	Tribeca	Fossil
LOCATION	GRADE	MANUFACTURER	PATTERN	COLOR

5. STEP - 3

5. Step 2	3	Momentum	Tribeca	Fossil
LOCATION	GRADE	MANUFACTURER	PATTERN	COLOR

FOOT

1" Nylon Glide	White	1
NAME/COLOR	COLOR	QUANTITY

EMBROIDERY*

Seat	Rocket Logo
LOCATION	NAME

FLAME RETARDANT*

CAL TB-133

*Optional add-ons. Reference product breakdown for availability.

INCLUDE ON PURCHASE ORDER

EXAMPLE CONFIGURATION

F028-38x38x32-G1-PI

1. Side: Grade 1, Spradling, Silvertex, Sage | 2. Back: Grade 3, Momentum, Tribeca, Fossil | 3. Step 1: Grade 3, Momentum, Tribeca, Fossil | 4. Step 2: Grade 3, Momentum, Tribeca, Fossil | 5. Step 3: Grade 3, Momentum, Tribeca, Fossil

Foot: 1" Nylon Glide | Power: White, Quantity: 1 | Embroidery: Seat, Rocket logo | CAL TB-133

PRODUCT BREAKDOWN

THREE STEP (F028)

Product No.	Dimen./Weight (L x W x H)	FOOT OPTIONS										INTEGRATED POWER OPTION						HPL	Emb.						
		Zip Z	Standard		3" Premium		6" Premium				Standard		3" Premium		6" Premium										
			G1	L1	R3	C3	S16	S29	C6	T6	R6	M6	G1	L1	R3	C3	S16			S29	C6	T6	R6	M6	
F028-38x38x32	38" x 38" x 32" 48 lbs.	-	✓	✓	-	-	-	-	-	-	-	✓	✓	-	-	-	-	-	-	-	-	-	-	-	✓

Fōmcore
SERVE. CREATE. INSPIRE.

1770 E. Keating Ave - Muskegon, MI 49442 • Tel: 231.366.4791 • www.fomcore.com

ADDITIONAL
RESOURCES



CLICK TO VIEW »