

8 7 6 5 4 3 2 1

ARROWS INDICATE FABRIC DIRECTION ON ROLL

REVISIONS			
REV.	DESCRIPTION OF CHANGE	DATE	ENG
A	created	8/8/2023	BBM

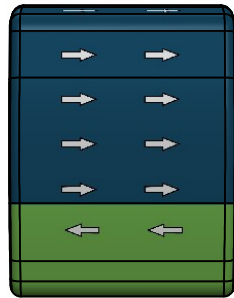
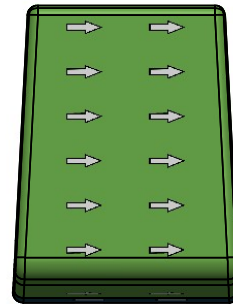
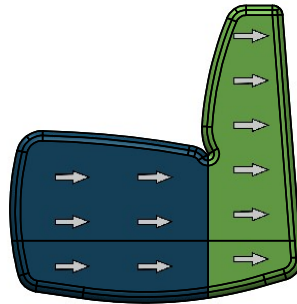
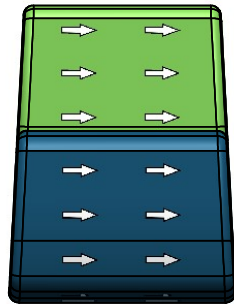
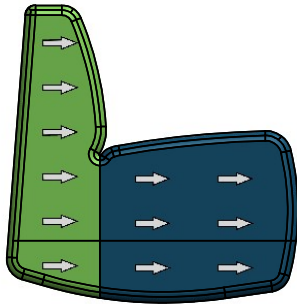
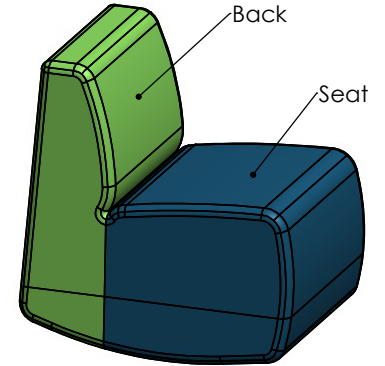
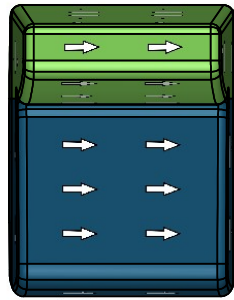
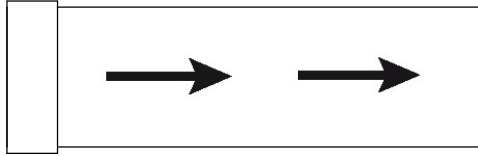

Default thread color to match surface 1

Default zipper color to match zippered surface

Surface #	Surface Name	Color
1	Seat	
2	Back	

WEIGHT	NAME	DATE
15.73 lbs	B. Matiga	8/8/2023

CUST APPRVD.

PROPRIETARY AND CONFIDENTIAL
 THE INFORMATION CONTAINED IN THIS DRAWING IS THE SOLE PROPERTY OF FOMCORE LLC. ANY REPRODUCTION IN PART OR AS A WHOLE WITHOUT THE WRITTEN PERMISSION OF FOMCORE LLC IS PROHIBITED.



		PART NO.	F165 Standard Colorguide	SHEET 1 OF 1
		DESCRIPTION	Rock-N-Roller Standard Colorguide	REV A

8 7 6 5 4 3 2 1