

8 7 6 5 4 3 2 1

ARROWS INDICATE FABRIC DIRECTION ON ROLL

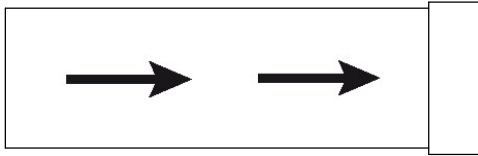

| REVISIONS | | | |
|-----------|-----------------------|-----------|-----|
| REV. | DESCRIPTION OF CHANGE | DATE | ENG |
| A | created | 7/29/2024 | BBM |

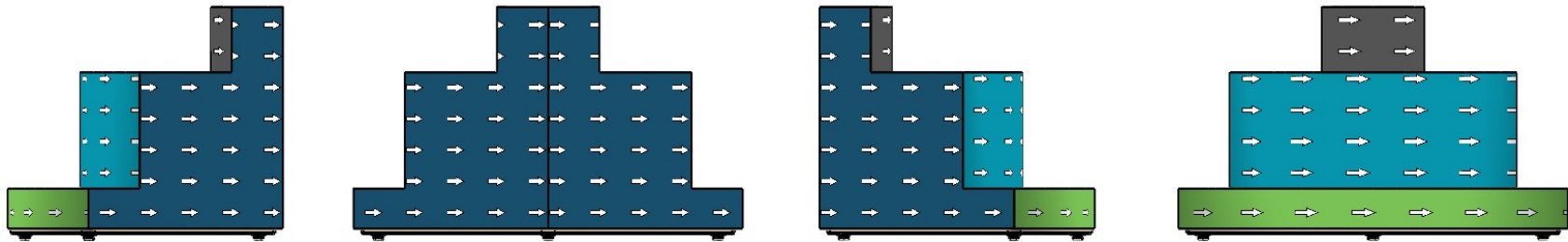
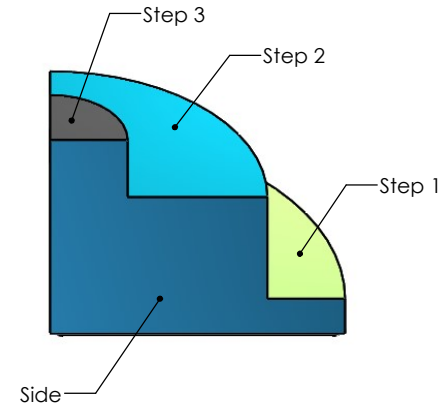
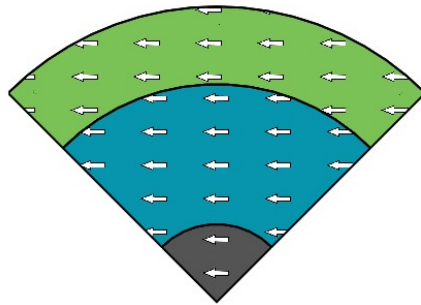

Default thread color to match surface 1

Default zipper color to match zippered surface

| Surface # | Surface Name | Color |
|-----------|--------------|-------|
| 1 | Side | |
| 2 | Step 1 | |
| 3 | Step2 | |
| 4 | Step3 | |

| WEIGHT | NAME | DATE |
|--------|-----------|----------|
| lbs | B. Matiga | 9/5/2024 |

CUST APPRVD.

PROPRIETARY AND CONFIDENTIAL
THE INFORMATION CONTAINED IN THIS DRAWING IS THE SOLE PROPERTY OF FOMCORE LLC. ANY REPRODUCTION IN PART OR AS A WHOLE WITHOUT THE WRITTEN PERMISSION OF FOMCORE LLC IS PROHIBITED.



| | |
|---|--------------|
| Drawing NO. F090-Standard Colorguide | SHEET 1 OF 1 |
| DESCRIPTION Three Step OUT Curved Corner Standard Colorguide | REV A |

8 7 6 5 4 3 2 1